



Fortinet AP1000

Installation Guide



882-70015 Rev A Ver 8

Copyright© 2015 Fortinet, Inc. All rights reserved. Fortinet® and certain other marks are registered trademarks of Fortinet, Inc., in the U.S. and other jurisdictions, and other Fortinet names herein may also be registered and/or common law trademarks of Fortinet. All other product or company names may be trademarks of their respective owners. Performance and other metrics contained herein were attained in internal lab tests under ideal conditions, and actual performance and other results may vary. Network variables, different network environments and other conditions may affect performance results. Nothing herein represents any binding commitment by Fortinet, and Fortinet disclaims all warranties, whether express or implied, except to the extent Fortinet enters a binding written contract, signed by Fortinet's General Counsel, with a purchaser that expressly warrants that the identified product will perform according to certain expressly-identified performance metrics and, in such event, only the specific performance metrics expressly identified in such binding written contract shall be binding on Fortinet. For absolute clarity, any such warranty will be limited to performance in the same ideal conditions as in Fortinet's internal lab tests. In no event does Fortinet make any commitment related to future deliverables, features or development, and circumstances may change such that any forward-looking statements herein are not accurate. Fortinet disclaims in full any covenants, representations, and guarantees pursuant hereto, whether express or implied. Fortinet reserves the right to change, modify, transfer, or otherwise revise this publication without notice, and the most current version of the publication shall be applicable.

Support

For assistance, contact Fortinet Customer Service and Support 24 hours a day at +1 408-542-7780, or by using one of the [local contact numbers](#), or through the Support portal at <https://support.fortinet.com/>

Fortinet Customer Service and Support provide end users and channel partners with the following:

- Technical Support
- Software Updates
- Parts replacement service

Fortinet Product License Agreement / EULA and Warranty Terms



To ensure a secured WiFi network, Fortinet hardware (controllers and access points) are designed to run only the proprietary firmware developed by Fortinet. Only approved Fortinet access points are configurable with Fortinet controllers and vice versa. Third party access points and software cannot be configured on Fortinet hardware

Trademarks and Copyright Statement

Fortinet®, FortiGate®, and FortiGuard® are registered trademarks of Fortinet, Inc., and other Fortinet names may also be trademarks, registered or otherwise, of Fortinet. All other product or company names may be trademarks of their respective owners. Copyright © 2015 Fortinet, Inc., All Rights reserved. Contents and terms are subject to change by Fortinet without prior notice. No part of this publication may be reproduced in any form or by any means or used to make any derivative such as translation, transformation, or adaptation without permission from Fortinet, Inc., as stipulated by the United States Copyright Act of 1976.

Product License Agreement

The parties to this agreement are you, the end customer, and either (i) where you have purchased your Product within the Americas, Fortinet, Inc., or (ii) where you have purchased your Product outside of the Americas, Fortinet Singapore Private Limited (each referred to herein as "Fortinet"). CAREFULLY READ THE FOLLOWING LEGAL AGREEMENT (THE OR THIS "AGREEMENT" OR "EULA"). USE OR INSTALLATION OF FORTINET PRODUCT(S) AND ANY UPDATES THERETO, INCLUDING HARDWARE APPLIANCE PRODUCTS, SOFTWARE AND FIRMWARE INCLUDED THEREIN BY FORTINET, AND STAND-ALONE SOFTWARE PRODUCTS SOLD BY FORTINET (TOGETHER, THE "PRODUCTS") CONSTITUTES ACCEPTANCE BY YOU OF THE TERMS IN THIS AGREEMENT, AS AMENDED OR UPDATED FROM TIME TO TIME IN FORTINET'S DISCRETION BY FORTINET PUBLISHING AN AMENDED OR UPDATED VERSION. FORTINET SHALL NOT BE BOUND BY ANY ADDITIONAL AND/OR CONFLICTING PROVISIONS IN ANY ORDER, RELEASE, ACCEPTANCE OR OTHER WRITTEN CORRESPONDENCE OR OTHER WRITTEN OR VERBAL COMMUNICATION UNLESS EXPRESSLY AGREED TO IN A WRITING SIGNED BY THE GENERAL COUNSEL OF FORTINET. IF YOU DO NOT AGREE TO ALL OF THE TERMS OF THIS AGREEMENT, DO NOT START THE INSTALLATION PROCESS OR USE THE PRODUCTS. IF YOU DO NOT AGREE TO THE TERMS OF THIS AGREEMENT, YOU SHOULD IMMEDIATELY, AND IN NO EVENT LATER THAN FIVE (5) CALENDAR DAYS AFTER YOUR RECEIPT OF THE PRODUCT IMMEDIATELY NOTIFY THE FORTINET LEGAL TEAM IN WRITING AT LEGAL@FORTINET.COM OF REQUESTED CHANGES TO THIS AGREEMENT.

1. License Grant.

This is a license, not a sales agreement, between you and Fortinet. The term "Software", as used throughout this Agreement, includes all Fortinet and third party firmware and software provided to you with, or incorporated into, Fortinet appliances and any stand-alone software provided to you by Fortinet, with the exception of any open source software contained in Fortinet's Products which is discussed in detail in section 15 below, and the term "Software" includes any accompanying documentation, any updates and enhancements of the software or firmware provided to you by Fortinet, at its option. Fortinet grants to you a non-transferable (except as provided in section 5 ("Transfer") and section 15 ("Open Source Software") below), non-exclusive, revocable (in the event of your failure to comply with these terms or in the event Fortinet is not properly paid for the applicable Product) license to use the Software solely for your internal business purposes (provided, if a substantial portion of your business is to provide managed service provider services to your end-customers, you may use the Software embedded in FortiGate and supporting hardware appliances to provide those services, subject to the other restrictions in this Agreement), in accordance with the terms set forth in this Agreement and subject to any further restrictions in Fortinet documentation, and solely on the Fortinet appliance, or, in the case of blades, CPUs or databases, on the single blade, CPU or database on which Fortinet installed the Software or, for stand-alone Software, solely on a single computer running a validly licensed copy of the operating system for which the Software was designed, or, in the case of blades, CPUs or databases, on a single blade, CPU or database. For clarity, notwithstanding anything to the contrary, all licenses of Software to be installed on blades, CPUs or databases are licensed on a per single blade, solely for one blade and not for multiple blades that may be installed in a chassis, per single CPU or per single database basis, as applicable. The Software is "in use" on any Fortinet appliances when it is loaded into temporary memory (i.e. RAM). You agree that, except for the limited, specific license rights granted in this section 1, you receive no license rights to the Software.

2. Limitation on Use.

You may not attempt to, and, if you are a corporation, you are responsible to prevent your employees and contractors from attempting to, (a) modify, translate, reverse engineer, decompile, disassemble, create derivative works based on, sublicense, or distribute the Software; (b) rent or lease any rights in the Software in any form to any third party or make the Software available or accessible to third parties in any other manner; (c) except as provided in section 5, transfer assign or sublicense right to any other person or entity, or (d) remove any proprietary notice, labels, or marks on the Software, Products, and containers.

3. Proprietary Rights.

All rights, title, interest, and all copyrights to the Software and any copy made thereof by you and to any Product remain with Fortinet. You acknowledge that no title to the intellectual property in the Software or other Products is transferred to you and you will not acquire any rights to the Software or other Products except for the specific license as expressly set forth in section 1 ("License Grant") above. You agree to keep confidential all Fortinet

confidential information and only to use such information for the purposes for which Fortinet disclosed it.

4. Term and Termination.

Except for evaluation and beta licenses or other licenses where the term of the license is limited per the evaluation/beta or other agreement or in the ordering documents, the term of the license is for the duration of Fortinet's copyright in the Software. Fortinet may terminate this Agreement, and the licenses and other rights herein, immediately without notice if you breach or fail to comply with any of the terms and conditions of this Agreement. You agree that, upon such termination, you will cease using the Software and any Product and either destroy all copies of the Fortinet documentation or return all materials to Fortinet. The provisions of this Agreement, other than the license granted in section 1 ("License Grant"), shall survive termination.

5. Transfer.

If you are a Fortinet contracted and authorized reseller or distributor of Products, you may transfer (not rent or lease unless specifically agreed to in writing by Fortinet) the Software to one end user on a permanent basis, provided that: (i) you ensure that your customer and the end user receives a copy of this Agreement, is bound by its terms and conditions, and, by selling the Product or Software, you hereby agree to enforce the terms in this Agreement against such end user, (ii) you at all times comply with all applicable United States export control laws and regulations, and (iii) you agree to refund any fees paid to you by an end user who purchased Product(s) from you but does not agree to the terms contained in this Agreement and therefore wishes to return the Product(s) as provided for in this Agreement. Further, if you are a non-authorized reseller of Products, you are not authorized to sell Product(s) or Software, but, regardless, by selling Product(s) or Software, you hereby agree you are bound by the restrictions and obligations herein and are bound to: (i) ensure that your customer and the end user receive a copy of this Agreement and are bound in full by all restrictions and obligations herein (ii) enforce the restrictions and obligations in this Agreement against such customer and/or end user, (iii) comply with all applicable United States export control laws and regulations and all other applicable laws, and (iv) refund any fees paid to you by a customer and/or end user who purchased Product(s) from you but does not agree to the restrictions and obligations contained in this Agreement and therefore wishes to return the Product(s) as provided for in this Agreement. Notwithstanding anything to the contrary, distributors, resellers and other Fortinet partners (a) are not agents of Fortinet and (b) are not authorized to bind Fortinet in any way.

6. Limited Warranty.

Fortinet provides this limited warranty for its product only to the single end-user person or entity that originally purchased the Product from Fortinet or its authorized reseller or distributor and paid for such Product. The warranty is only valid for Products which are properly registered on Fortinet's Support Website, <https://support.fortinet.com>, or such other website as provided by Fortinet, or for which the warranty otherwise

starts according to Fortinet's policies. The warranty periods discussed below will start according to Fortinet's policies posted at <http://www.fortinet.com/aboutus/legal.html> or such other website as provided by Fortinet. It is the Fortinet distributor's and reseller's responsibility to make clear to the end user the date the product was originally shipped from Fortinet, and it is the end user's responsibility to understand the original ship date from the party from which the end user purchased the product. All warranty claims must be submitted in writing to Fortinet before the expiration of the warranty term or such claims are waived in full. Fortinet provides no warranty for any beta, donation or evaluation Products, for any spare parts not purchased directly from Fortinet by the end-user, for any accessories, or for any stand-alone software. Fortinet warrants that the hardware portion of the Products, including spare parts unless noted otherwise ("Hardware") will be free from material defects in workmanship as compared to the functional specifications for the period set forth as follows and applicable to the Product type ("Hardware Warranty Period"): a three hundred sixty-five (365) day limited warranty for the Hardware excluding spare parts, power supplies, and accessories (provided, solely with respect to FortiAP and Meru AP indoor Wi-Fi access point Hardware appliance products and FortiSwitch Hardware appliance products other than the FortiSwitch-5000 series (for both excluding spare parts, power supplies, and accessories), the warranty herein shall last from the start of the warranty period as discussed above until five (5) years following the product announced end-of-life date), and, for spare parts, power supplies, and accessories, solely a ninety (90) days limited warranty. Fortinet's sole obligation shall be to repair or offer replacement Hardware for the defective Hardware at no charge to the original owner. This obligation is exclusive of transport fees, labor, de-installation, installation, reconfiguration, or return shipment and handling fees and costs, and Fortinet shall have no obligation related thereto. Such repair or replacement will be rendered by Fortinet at an authorized Fortinet service facility as determined by Fortinet. The replacement Hardware need not be new or of an identical make, model, or part; Fortinet may, in its discretion, replace the defective Hardware (or any part thereof) with any reconditioned Product that Fortinet reasonably determines is substantially equivalent (or superior) in all material respects to the defective Hardware. The Hardware Warranty Period for the repaired or replacement Hardware shall be for the greater of the remaining Hardware Warranty Period or ninety days from the delivery of the repaired or replacement Hardware. If Fortinet determines in its reasonable discretion that a material defect is incapable of correction or that it is not practical to repair or replace defective Hardware, the price paid by the original purchaser for the defective Hardware will be refunded by Fortinet upon return to Fortinet of the defective Hardware. All Hardware (or part thereof) that is replaced by Fortinet, or for which the purchase price is refunded, shall become the property of Fortinet upon replacement or refund. Fortinet warrants that the software as initially shipped with the Hardware Products will substantially conform to Fortinet's then current functional specifications for the Software, as set forth in the applicable documentation for a period of ninety (90) days ("Software Warranty Period"), if the Software is properly installed on approved Hardware and operated as contemplated in its documentation. Fortinet's sole obligation shall be to repair or offer replacement Software for the non-conforming Software with software that substantially conforms to Fortinet's functional specifications. This obligation is exclusive of transport fees, labor, de-installation, installation, reconfiguration, or return shipment and handling fees and costs, and Fortinet shall have no obligation related thereto. Except as otherwise agreed by

Fortinet in writing, the warranty replacement Software is provided only to the original licensee, and is subject to the terms and conditions of the license granted by Fortinet for the Software. The Software Warranty Period shall extend for an additional ninety (90) days after any warranty replacement software is delivered. If Fortinet determines in its reasonable discretion that a material non-conformance is incapable of correction or that it is not practical to repair or replace the non-conforming Software, the price paid by the original licensee for the non-conforming Software will be refunded by Fortinet; provided that the non-conforming Software (and all copies thereof) is first returned to Fortinet. The license granted respecting any Software for which a refund is given automatically terminates immediately upon refund. For purpose of the above hardware and software warranties, the term "functional specifications" means solely those specifications authorized and published by Fortinet that expressly state in such specifications that they are the functional specifications referred to in this section 6 of this Agreement, and, in the event no such specifications are provided to you with the Software or Hardware, there shall be no warranty on such Software.

7. Disclaimer of Other Warranties and Restrictions.

EXCEPT FOR THE LIMITED WARRANTY SPECIFIED IN SECTION 6 ABOVE, THE PRODUCT AND SOFTWARE ARE PROVIDED "AS-IS" WITHOUT ANY WARRANTY OF ANY KIND INCLUDING, WITHOUT LIMITATION, ANY IMPLIED WARRANTY, IMPLIED OR EXPRESS WARRANTY OF MERCHANTABILITY, OR WARRANTY FOR FITNESS FOR A PARTICULAR PURPOSE AND NON-INFRINGEMENT. IF ANY IMPLIED WARRANTY CANNOT BE DISCLAIMED IN ANY TERRITORY WHERE A PRODUCT IS SOLD, THE DURATION OF SUCH IMPLIED WARRANTY SHALL BE LIMITED TO NINETY (90) DAYS FROM THE DATE OF ORIGINAL SHIPMENT FROM FORTINET. EXCEPT AS EXPRESSLY COVERED UNDER THE LIMITED WARRANTY PROVIDED HEREIN, THE ENTIRE RISK AS TO THE QUALITY, SELECTION AND PERFORMANCE OF THE PRODUCT IS WITH THE PURCHASER OF THE PRODUCT. NOTWITHSTANDING ANYTHING TO THE CONTRARY, THE HARDWARE WARRANTY PERIOD DISCUSSED ABOVE DOES NOT APPLY TO CERTAIN FORTINET PRODUCTS, INCLUDING FORTITOKEN WHICH HAS A 365 DAY WARRANTY FROM THE DATE OF SHIPMENT FROM FORTINET'S FACILITIES, AND THE SOFTWARE WARRANTY DOES NOT APPLY TO CERTAIN FORTINET PRODUCTS, INCLUDING FORTIGATE-ONE AND VDOM SOFTWARE. YOU HEREBY ACKNOWLEDGE AND AGREE THAT NO VENDOR CAN ASSURE COMPLETE SECURITY AND NOTHING HEREIN OR ELSEWHERE SHALL BE DEEMED TO IMPLY A SECURITY GUARANTEE OR ASSURANCE. The warranty in Section 6 above does not apply if the Software, Product or any other equipment upon which the Software is authorized to be used (a) has been altered, except by Fortinet or its authorized representative, (b) has not been installed, operated, repaired, updated to the latest version, or maintained in accordance with instructions supplied by Fortinet, (c) has been subjected to abnormal physical or electrical stress, misuse, negligence, or accident; (d) is licensed for beta, evaluation, donation, testing or demonstration purposes or for which Fortinet does not charge a purchase price or license fee. In the case of beta, testing, evaluation, donation or free Software or Product, the end user acknowledges and agrees that such Software or Product may contain bugs or

errors and could cause system failures, data loss and other issues, and the end user agrees that such Software or Product is provided “as-is” without any warranty whatsoever, and Fortinet disclaims any warranty or liability whatsoever. An end user’s use of evaluation or beta Software or Product is limited to thirty (30) days from original shipment unless otherwise agreed in writing by Fortinet.

8. Governing Law.

Any disputes arising out of this Agreement or Fortinet’s limited warranty shall be governed by the laws of the state of California, without regard to the conflict of laws principles. In the event of any disputes arising out of this Agreement or Fortinet’s limited warranty, the parties submit to the jurisdiction of the federal and state courts located in Santa Clara County, California, as applicable.

9. Limitation of Liability.

TO THE MAXIMUM EXTENT PERMITTED BY LAW AND NOTWITHSTANDING ANYTHING TO THE CONTRARY, FORTINET IS NOT LIABLE UNDER ANY CONTRACT, NEGLIGENCE, TORT, STRICT LIABILITY, INFRINGEMENT OR OTHER LEGAL OR EQUITABLE THEORY FOR ANY LOSS OF USE OF THE PRODUCT OR SERVICE OR ANY DAMAGES OF ANY KIND WHATSOEVER, WHETHER DIRECT, SPECIAL, INCIDENTAL OR CONSEQUENTIAL (INCLUDING, BUT NOT LIMITED TO, DAMAGES FOR LOSS OF GOODWILL, LOSS OF PROFIT, LOSS OF OPPORTUNITY, LOSS OR DAMAGE RELATED TO USE OF THE PRODUCT OR SERVICE IN CONNECTION WITH HIGH RISK ACTIVITIES, DE-INSTALLATION AND INSTALLATION FEES AND COSTS, DAMAGE TO PERSONAL OR REAL PROPERTY, WORK STOPPAGE, COMPUTER FAILURE OR MALFUNCTION, COMPUTER SECURITY BREACH, COMPUTER VIRUS INFECTION, LOSS OF INFORMATION OR DATA CONTAINED IN, STORED ON, OR INTEGRATED WITH ANY PRODUCT INCLUDING ANY PRODUCT RETURNED TO FORTINET FOR WARRANTY SERVICE) RESULTING FROM THE USE OF THE PRODUCT, RELATING TO WARRANTY SERVICE, OR ARISING OUT OF ANY BREACH OF THE LIMITED WARRANTY IN SECTION 6 ABOVE, EVEN IF FORTINET HAS BEEN ADVISED OF THE POSSIBILITY OF SUCH DAMAGES. THE SOLE REMEDY FOR A BREACH OF THE LIMITED WARRANTY IS REPAIR, REPLACEMENT OR REFUND OF THE DEFECTIVE OR NONCONFORMING PRODUCT AS SPECIFICALLY STATED IN SECTION 6 ABOVE.

10. Import / Export Requirements; FCPA Compliance.

You are advised that the Products may be subject to the United States Export Administration Regulations and other import and export laws; diversion contrary to United States law and regulation is prohibited. You agree to comply with all applicable international and national laws that apply to the Products as well as end user, end-use, and destination restrictions issued by U.S. and other governments. For additional information on U.S. export controls see www.bis.doc.gov. Fortinet assumes no responsibility or liability for your failure to obtain any

necessary import and export approvals, and Fortinet reserves the right to terminate or suspend shipments, services and support in the event Fortinet has a reasonable basis to suspect any import or export violation. You represent that neither the United States Bureau of Industry and Security nor any other governmental agency has issued sanctions against you or otherwise suspended, revoked or denied your export privileges. You agree not to use or transfer the Products for any use relating to nuclear, chemical or biological weapons, or missile technology, unless authorized by the United States Government by regulation or specific written license. Additionally, you agree not to directly or indirectly export, import or transmit the Products contrary to the laws or regulations of any other governmental entity that has jurisdiction over such export, import, transmission or use. Furthermore, you represent that you understand, and you hereby agree to comply with, all requirements of the U.S. Foreign Corrupt Practices Act and all other applicable laws. For beta, testing, evaluation, donation or free Products and/or related services, you hereby agree, represent and warrant to Fortinet that (a) receipt of the Products and/or services comply with all policies and you have obtained all necessary approvals for such Products and/or services, (b) the Products and/or services are not provided in exchange for Fortinet maintaining current business or for new business opportunities, and (c) the Products and/or services are not being received for the benefit of, and are not being transferred to, any government entity, representative or affiliate.

11. U.S. Government End Users.

The Software and accompanying documentation are deemed to be "commercial computer software" and "commercial computer software documentation," respectively, pursuant to DFAR Section 227.7202 and FAR Section 12.212, as applicable. Any use, modification, reproduction, release, performance, display or disclosure of the Software and accompanying documentation by the United States Government shall be governed solely by the terms of this Agreement and shall be prohibited except to the extent expressly permitted by the terms of this Agreement and its successors.

12. Tax Liability.

You agree to be responsible for payment of any sales or use taxes imposed at any time on this transaction.

13. General Provisions.

Except as specifically permitted and required in section 5 ("Transfer") above, you agree not to assign this Agreement or transfer any of the rights or obligations under this Agreement without the prior written consent of Fortinet. This Agreement shall be binding upon, and inure to the benefit of, the successors and permitted assigns of the parties. The United Nations Convention on Contracts for the International Sales of Goods is expressly excluded. This Agreement and other Fortinet agreements may be amended or supplemented only by a writing that refers explicitly to the agreement signed on behalf of both parties, or, for this Agreement, as otherwise expressly provided in the lead-in above Section 1 above, provided, notwithstanding anything to the contrary and except for this Agreement which may be amended or updated as expressly provided in the lead-in above Section 1 above, for any amendment or other agree-

ment to be binding on Fortinet, such amendment or other agreement must be signed by Fortinet's General Counsel. No waiver will be implied from conduct or failure to enforce rights nor effective unless in a writing signed on behalf of the party against whom the waiver is asserted. If any part of this Agreement is found unenforceable, that part will be enforced to the maximum extent permitted and the remainder shall continue in full force and effect. You acknowledge that you have read this Agreement, understand it, and agree to be bound by its terms and conditions.

14. Privacy.

For information regarding Fortinet's collection, use and transfer of your personal information please read the Fortinet privacy policy on the Fortinet web site (<http://www.fortinet.com/aboutus/privacy.html>).

15. Open Source Software.

Fortinet's products may include software modules that are licensed (or sublicensed) to the user under the GNU General Public License, Version 2, of June 1991 ("GPL") or GNU Lesser General Public License, Version 2.1, of February 1999 ("LGPL") or other open source software licenses which, among other rights, permit the user to use, copy, modify and redistribute modules, or portions thereof, and may also require attribution disclosures and access to the source code ("Open Source Software"). The GPL requires that for any Open Source Software covered under the GPL, which is distributed to someone in an executable binary format, that the source code also be made available to those users. For any Open Source Software covered under the GPL, the source code is made available on this CD or download package. If any Open Source Software licenses require that Fortinet provide rights to use, copy or modify a Open Source Software program that are broader than the rights granted in this agreement, then such rights shall take precedence over the rights and restrictions herein. Fortinet will provide, for a charge reflecting our standard distribution costs, the complete machine-readable copy of the modified software modules. To obtain a complete machine-readable copy, please send your written request, along with a check in the amount of US \$25.00, to General Public License Source Code Request, Fortinet, Inc., 899 Kifer Rd, Sunnyvale, CA 94086 USA. In order to receive the modified software modules, you must also include the following information: (a) Name, (b) Address, (c) Telephone number, (d) E-mail Address, (e) Product purchased (if applicable), (f) Product Serial Number (if applicable). All open source software modules are licensed free of charge. There is no warranty for these modules, to the extent permitted by applicable law. The copyright holders provide these software modules "AS-IS" without warranty of any kind, either expressed or implied. In no event will the copyright holder for the open source software be liable to you for damages, including any special, incidental or consequential damages arising out of the use or inability to use the software modules, even if such holder has been advised of the possibility of such damages. A full copy of this license, including additional open source software license disclosures and third party license disclosures applicable to certain Fortinet products, may be obtained by contacting Fortinet's Legal Department at legal@fortinet.com.

GNU GENERAL PUBLIC LICENSE GNU GENERAL PUBLIC LICENSE

Version 2, June 1991

Copyright (C) 1989, 1991 Free Software Foundation, Inc.

59 Temple Place, Suite 330, Boston, MA 02111-1307 USA

TERMS AND CONDITIONS FOR COPYING, DISTRIBUTION AND MODIFICATION

This License applies to any program or other work which contains a notice placed by the copyright holder saying it may be distributed under the terms of this General Public License. The "Program", below, refers to any such program or work, and a "work based on the Program" means either the Program or any derivative work under copyright law: that is to say, a work containing the Program or a portion of it, either verbatim or with modifications and/or translated into another language. (Hereinafter, translation is included without limitation in the term "modification".) Each licensee is addressed as "you". Activities other than copying, distribution and modification are not covered by this License; they are outside its scope. The act of running the Program is not restricted, and the output from the Program is covered only if its contents constitute a work based on the Program (independent of having been made by running the Program). Whether that is true depends on what the

Program does.

1. You may copy and distribute verbatim copies of the Program's source code as you receive it, in any medium, provided that you conspicuously and appropriately publish on each copy an appropriate copyright notice and disclaimer of warranty; keep intact all the notices that refer to this License and to the absence of any warranty; and give any other recipients of the Program a copy of this License along with the Program. You may charge a fee for the physical act of transferring a copy, and you may at your option offer warranty protection in exchange for a fee.

2. You may modify your copy or copies of the Program or any portion of it, thus forming a work based on the Program, and copy and distribute such modifications or work under the terms of Section 1 above, provided that you also meet all of these conditions:

a) You must cause the modified files to carry prominent notices stating that you changed the files and the date of any change.

b) You must cause any work that you distribute or publish, that in whole or in part contains or is derived from the Program or any part thereof, to be licensed as a whole at no charge to all third parties under the terms of this License.

c) If the modified program normally reads commands interactively when run, you must cause it, when started running for such interactive use in the most ordinary way, to print or display an announcement including an appropriate copyright notice and a notice that there is no warranty (or else, saying that you provide a warranty) and that users may redistribute the program under these conditions, and telling the user how to view a copy of this License. (Exception: if

the Program itself is interactive but does not normally print such an announcement, your work based on the Program is not required to print an announcement.) These requirements apply to the modified work as a whole. If identifiable sections of that work are not derived from the Program, and can be reasonably considered independent and separate works in themselves, then this License, and its terms, do not apply to those sections when you distribute them as separate works. But when you distribute the same sections as part of a whole which is a work based on the Program, the distribution of the whole must be on the terms of this License, whose permissions for other licensees extend to the entire whole, and thus to each and every part regardless of who wrote it.. Thus, it is not the intent of this section to claim rights or contest your rights to work written entirely by you; rather, the intent is to exercise the right to control the distribution of derivative or collective works based on the Program. In addition, mere aggregation of another work not based on the Program with the Program (or with a work based on the Program) on a volume of a storage or distribution medium does not bring the other work under the scope of this License.

3. You may copy and distribute the Program (or a work based on it, under Section 2) in object code or executable form under the terms of Sections 1 and 2 above provided that you also do one of the following:

- a) Accompany it with the complete corresponding machine-readable source code, which must be distributed under the terms of Sections 1 and 2 above on a medium customarily used for software interchange; or,
- b) Accompany it with a written offer, valid for at least three years, to give any third party, for a charge no more than your cost of physically performing source distribution, a complete machine-readable copy of the corresponding source code, to be distributed under the terms of Sections 1 and 2 above on a medium customarily used for software interchange; or,
- c) Accompany it with the information you received as to the offer to distribute corresponding source code. (This alternative is allowed only for noncommercial distribution and only if you received the program in object code or executable form with such an offer, in accord with Subsection b above.)

Source code for a work means the preferred form of the work for making modifications to it. For an executable work, complete source code means all the source code for all modules it contains, plus any associated interface definition files, plus the scripts used to control compilation and installation of the executable. However, as a special exception, the source code distributed need not include anything that is normally distributed (in either source or binary form) with the major components (compiler, kernel, and so on) of the operating system on which the executable runs, unless that component itself accompanies the executable. If distribution of executable or object code is made by offering access to copy from a designated place, then offering equivalent access to copy the source code from the same place counts as distribution of the source code, even though third parties are not compelled to copy the source along with the object code.

4. You may not copy, modify, sublicense, or distribute the Program except as expressly provided under this License. Any attempt otherwise to copy, modify, sublicense or distribute the Program is void, and will automatically terminate your rights under this License. However, parties who have received copies, or rights, from you under this License will not have their licenses terminated so long as such parties remain in full compliance.

5. You are not required to accept this License, since you have not signed it. However, nothing else grants you permission to modify or distribute the Program or its derivative works. These actions are prohibited by law if you do not accept this License. Therefore, by modifying or distributing the Program (or any work based on the Program), you indicate your acceptance of this License to do so, and all its terms and conditions for copying, distributing or modifying the Program or works based on it.

6. Each time you redistribute the Program (or any work based on the Program), the recipient automatically receives a license from the original licensor to copy, distribute or modify the Program subject to these terms and conditions. You may not impose any further restrictions on the recipients' exercise of the rights granted herein. You are not responsible for enforcing compliance by third parties to this License.

7. If, as a consequence of a court judgment or allegation of patent infringement or for any other reason (not limited to patent issues), conditions are imposed on you (whether by court order, agreement or otherwise) that contradict the conditions of this License, they do not excuse you from the conditions of this License. If you cannot distribute so as to satisfy simultaneously your obligations under this License and any other pertinent obligations, then as a consequence you may not distribute the Program at all. For example, if a patent license would not permit royalty-free redistribution of the Program by all those who receive copies directly or indirectly through you, then the only way you could satisfy both it and this License would be to refrain entirely from distribution of the Program.

If any portion of this section is held invalid or unenforceable under any particular circumstance, the balance of the section is intended to apply and the section as a whole is intended to apply in other circumstances.

It is not the purpose of this section to induce you to infringe any patents or other property right claims or to contest validity of any such claims; this section has the sole purpose of protecting the integrity of the free software distribution system, which is implemented by public license practices. Many people have made generous contributions to the wide range of software distributed through that system in reliance on consistent application of that system; it is up to the author/donor to decide if he or she is willing to distribute software through any other system and a licensee cannot impose that choice.

This section is intended to make thoroughly clear what is believed to be a consequence of the rest of this License.

8. If the distribution and/or use of the Program is restricted in certain countries either by patents or by copyrighted interfaces, the original copyright holder who places the Program under

this License may add an explicit geographical distribution limitation excluding those countries, so that distribution is permitted only in or among countries not thus excluded. In such case, this License incorporates the limitation as if written in the body of this License.

9. The Free Software Foundation may publish revised and/or new versions of the General Public License from time to time. Such new versions will be similar in spirit to the present version, but may differ in detail to address new problems or concerns. Each version is given a distinguishing version number. If the Program specifies a version number of this License which applies to it and "any later version", you have the option of following the terms and conditions either of that version or of any later version published by the Free Software Foundation. If the Program does not specify a version number of this License, you may choose any version ever published by the Free Software Foundation.

10. If you wish to incorporate parts of the Program into other free programs whose distribution conditions are different, write to the author to ask for permission. For software which is copyrighted by the Free Software Foundation, write to the Free Software Foundation; we sometimes make exceptions for this. Our decision will be guided by the two goals of preserving the free status of all derivatives of our free software and of promoting the sharing and reuse of software generally.

NO WARRANTY

11. BECAUSE THE PROGRAM IS LICENSED FREE OF CHARGE, THERE IS NO WARRANTY FOR THE PROGRAM, TO THE EXTENT PERMITTED BY APPLICABLE LAW. EXCEPT WHEN OTHERWISE STATED IN WRITING THE COPYRIGHT HOLDERS AND/OR OTHER PARTIES PROVIDE THE PROGRAM "AS IS" WITHOUT WARRANTY OF ANY KIND, EITHER EXPRESSED OR IMPLIED, INCLUDING, BUT NOT LIMITED TO, THE IMPLIED WARRANTIES OF MERCHANTABILITY AND FITNESS FOR A PARTICULAR PURPOSE. THE ENTIRE RISK AS TO THE QUALITY AND PERFORMANCE OF THE PROGRAM IS WITH YOU. SHOULD THE PROGRAM PROVE DEFECTIVE, YOU ASSUME THE COST OF ALL NECESSARY SERVICING, REPAIR OR CORRECTION.

12. IN NO EVENT UNLESS REQUIRED BY APPLICABLE LAW OR AGREED TO IN WRITING WILL ANY COPYRIGHT HOLDER, OR ANY OTHER PARTY WHO MAY MODIFY AND/OR REDISTRIBUTE THE PROGRAM AS PERMITTED ABOVE, BE LIABLE TO YOU FOR DAMAGES, INCLUDING ANY GENERAL, SPECIAL, INCIDENTAL OR CONSEQUENTIAL DAMAGES ARISING OUT OF THE USE OR INABILITY TO USE THE PROGRAM (INCLUDING BUT NOT LIMITED TO LOSS OF DATA OR DATA BEING RENDERED INACCURATE OR LOSSES SUSTAINED BY YOU OR THIRD PARTIES OR A FAILURE OF THE PROGRAM TO OPERATE WITH ANY OTHER PROGRAMS), EVEN IF SUCH HOLDER OR OTHER PARTY HAS BEEN ADVISED OF THE POSSIBILITY OF SUCH DAMAGES.

GNU LESSER GENERAL PUBLIC LICENSE

Version 2.1, February 1999

Copyright (C) 1991, 1999 Free Software Foundation, Inc.

59 Temple Place, Suite 330, Boston, MA 02111-1307 USA

TERMS AND CONDITIONS FOR COPYING, DISTRIBUTION AND MODIFICATION

0. This License Agreement applies to any software library or other program which contains a notice placed by the copyright holder or other authorized party saying it may be distributed under the terms of this Lesser General Public License (also called "this License"). Each licensee is addressed as "you".

A "library" means a collection of software functions and/or data prepared so as to be conveniently linked with application programs (which use some of those functions and data) to form executables.

The "Library", below, refers to any such software library or work which has been distributed under these terms. A "work based on the Library" means either the Library or any derivative work under copyright law: that is to say, a work containing the Library or a portion of it, either verbatim or with modifications and/or translated straightforwardly into another language. (Hereinafter, translation is included without limitation in the term "modification".)

"Source code" for a work means the preferred form of the work for making modifications to it. For a library, complete source code means all the source code for all modules it contains, plus any associated interface definition files, plus the scripts used to control compilation and installation of the library.

Activities other than copying, distribution and modification are not covered by this License; they are outside its scope. The act of running a program using the Library is not restricted, and output from such a program is covered only if its contents constitute a work based on the Library (independent of the use of the Library in a tool for writing it). Whether that is true depends on what the Library does and what the program that uses the Library does.

1. You may copy and distribute verbatim copies of the Library's complete source code as you receive it, in any medium, provided that you conspicuously and appropriately publish on each copy an appropriate copyright notice and disclaimer of warranty; keep intact all the notices that refer to this License and to the absence of any warranty; and distribute a copy of this License along with the Library. You may charge a fee for the physical act of transferring a copy, and you may at your option offer warranty protection in exchange for a fee.

2. You may modify your copy or copies of the Library or any portion of it, thus forming a work based on the Library, and copy and distribute such modifications or work under the terms of Section 1 above, provided that you also meet all of these conditions:

- a) The modified work must itself be a software library.
- b) You must cause the files modified to carry prominent notices stating that you changed the files and the date of any change.
- c) You must cause the whole of the work to be licensed at no charge to all third parties under the terms of this License.
- d) If a facility in the modified Library refers to a function or a table of data to be supplied by an application program that uses the facility, other than as an argument passed when the facility is invoked, then you must make a good faith effort to ensure that, in the event an application does not supply such function or table, the facility still operates, and performs whatever part of its purpose remains meaningful.

These requirements apply to the modified work as a whole. If identifiable sections of that work are not derived from the Library, and can be reasonably considered independent and separate works in themselves, then this License, and its terms, do not apply to those sections when you distribute them as separate works. But when you distribute the same sections as part of a whole which is a work based on the Library, the distribution of the whole must be on the terms of this License, whose permissions for other licensees extend to the entire whole, and thus to each and every part regardless of who wrote it. Thus, it is not the intent of this section to claim rights or contest your rights to work written entirely by you; rather, the intent is to exercise the right to control the distribution of derivative or collective works based on the Library. In addition, mere aggregation of another work not based on the Library with the Library (or with a work based on the Library) on a volume of a storage or distribution medium does not bring the other work under the scope of this License.

3. You may opt to apply the terms of the ordinary GNU General Public License instead of this License to a given copy of the Library. To do this, you must alter all the notices that refer to this License, so that they refer to the ordinary GNU General Public License, version 2 instead of to this License. (If a newer version than version 2 of the ordinary GNU General Public License has appeared, then you can specify that version instead if you wish.) Do not make any other change in these notices.

Once this change is made in a given copy, it is irreversible for that copy, so the ordinary GNU General Public License applies to all subsequent copies and derivative works made from that copy. This option is useful when you wish to copy part of the code of the Library into a program that is not a library.

4. You may copy and distribute the Library (or a portion or derivative of it, under Section 2) in object code or executable form under the terms of Sections 1 and 2 above provided that you accompany it with the complete corresponding machine-readable source code, which must be distributed under the terms of Sections 1 and 2 above on a medium customarily used for software interchange.

If distribution of object code is made by offering access to copy from a designated place, then offering equivalent access to copy the source code from the same place satisfies the requirement to distribute the source code, even though third parties are not compelled to copy the source along with the object code.

5. A program that contains no derivative of any portion of the Library, but is designed to work with the Library by being compiled or linked with it, is called a "work that uses the Library". Such a work, in isolation, is not a derivative work of the Library, and therefore falls outside the scope of this License.

However, linking a "work that uses the Library" with the Library creates an executable that is a derivative of the Library (because it contains portions of the Library), rather than a "work that uses the library". The executable is therefore covered by this License. Section 6 states terms for distribution of such executables.

When a "work that uses the Library" uses material from a header file that is part of the Library, the object code for the work may be a derivative work of the Library even though the source code is not.

Whether this is true is especially significant if the work can be linked without the Library, or if the work is itself a library. The threshold for this to be true is not precisely defined by law.

If such an object file uses only numerical parameters, data structure layouts and accessors, and small macros and small inline functions (ten lines or less in length), then the use of the object file is unrestricted, regardless of whether it is legally a derivative work. (Executables containing this object code plus portions of the Library will still fall under Section 6.) Otherwise, if the work is a derivative of the Library, you may distribute the object code for the work under the terms of Section 6. Any executables containing that work also fall under Section 6, whether or not they are linked directly with the Library itself.

6. As an exception to the Sections above, you may also combine or link a "work that uses the Library" with the Library to produce a work containing portions of the Library, and distribute that work under terms of your choice, provided that the terms permit modification of the work for your own use and reverse engineering for debugging such modifications. You must give prominent notice with each copy of the work that the Library is used in it and that the Library and its use are covered by this License. You must supply a copy of this License. If the work during execution displays copyright notices, you must include the copyright notice for the Library among them, as well as a reference directing the user to the copy of this License. Also, you must do one of these things:

a) Accompany the work with the complete corresponding machine-readable source code for the Library including whatever changes were used in the work (which must be distributed under Sections 1 and 2 above); and, if the work is an executable linked with the Library, with the complete machine-readable "work that uses the Library", as object code and/or source code, so that the user can modify the Library and then relink to produce a modified executable containing the modified Library. (It is understood that the user who changes the contents of

definitions files in the Library will not necessarily be able to recompile the application to use the modified definitions.)

b) Use a suitable shared library mechanism for linking with the Library. A suitable mechanism is one that (1) uses at run time a copy of the library already present on the user's computer system, rather than copying library functions into the executable, and (2) will operate properly with a modified version of the library, if the user installs one, as long as the modified version is interface-compatible with the version that the work was made with.

c) Accompany the work with a written offer, valid for at least three years, to give the same user the materials specified in Subsection 6a, above, for a charge no more than the cost of performing this distribution.

d) If distribution of the work is made by offering access to copy from a designated place, offer equivalent access to copy the above specified materials from the same place.

e) Verify that the user has already received a copy of these materials or that you have already sent this user a copy. For an executable, the required form of the "work that uses the Library" must include any data and utility programs needed for reproducing the executable from it. However, as a special exception, the materials to be distributed need not include anything that is normally distributed (in either source or binary form) with the major components (compiler, kernel, and so on) of the operating system on which the executable runs, unless that component itself accompanies the executable. It may happen that this requirement contradicts the license restrictions of other proprietary libraries that do not normally accompany the operating system. Such a contradiction means you cannot use both them and the Library together in an executable that you distribute.

7. You may place library facilities that are a work based on the Library side-by-side in a single library together with other library facilities not covered by this License, and distribute such a combined library, provided that the separate distribution of the work based on the Library and of the other library facilities is otherwise permitted, and provided that you do these two things:

a) Accompany the combined library with a copy of the same work based on the Library, uncombined with any other library facilities. This must be distributed under the terms of the Sections above.

b) Give prominent notice with the combined library of the fact that part of it is a work based on the Library, and explaining where to find the accompanying uncombined form of the same work.

8. You may not copy, modify, sublicense, link with, or distribute the Library except as expressly provided under this License. Any attempt otherwise to copy, modify, sublicense, link with, or distribute the Library is void, and will automatically terminate your rights under this License. However, parties who have received copies, or rights, from you under this License will not have their licenses terminated so long as such parties remain in full compliance.

9. You are not required to accept this License, since you have not signed it. However, nothing else grants you permission to modify or distribute the Library or its derivative works. These actions are prohibited by law if you do not accept this License. Therefore, by modifying or distributing the Library (or any work based on the Library), you indicate your acceptance of this

License to do so, and all its terms and conditions for copying, distributing or modifying the Library or works based on it.

10. Each time you redistribute the Library (or any work based on the Library), the recipient automatically receives a license from the original licensor to copy, distribute, link with or modify the Library subject to these terms and conditions. You may not impose any further restrictions on the recipients' exercise of the rights granted herein. You are not responsible for enforcing compliance by third parties with this License.

11. If, as a consequence of a court judgment or allegation of patent infringement or for any other reason (not limited to patent issues), conditions are imposed on you (whether by court order, agreement or otherwise) that contradict the conditions of this License, they do not excuse you from the conditions of this License. If you cannot distribute so as to satisfy simultaneously your obligations under this License and any other pertinent obligations, then as a consequence you may not distribute the Library at all. For example, if a patent license would not permit royalty-free redistribution of the Library by all those who receive copies directly or indirectly through you, then the only way you could satisfy both it and this License would be to refrain entirely from distribution of the Library.

If any portion of this section is held invalid or unenforceable under any particular circumstance, the balance of the section is intended to apply, and the section as a whole is intended to apply in other circumstances.

It is not the purpose of this section to induce you to infringe any patents or other property right claims or to contest validity of any such claims; this section has the sole purpose of protecting the integrity of the free software distribution system which is implemented by public license practices. Many people have made generous contributions to the wide range of software distributed through that system in reliance on consistent application of that system; it is up to the author/donor to decide if he or she is willing to distribute software through any other system and a licensee cannot impose that choice. This section is intended to make thoroughly clear what is believed to be a consequence of the rest of this License.

12. If the distribution and/or use of the Library is restricted in certain countries either by patents or by copyrighted interfaces, the original copyright holder who places the Library under this License may add an explicit geographical distribution limitation excluding those countries, so that distribution is permitted only in or among countries not thus excluded. In such case, this License incorporates the limitation as if written in the body of this License.

13. The Free Software Foundation may publish revised and/or new versions of the Lesser General Public License from time to time. Such new versions will be similar in spirit to the present version, but may differ in detail to address new problems or concerns. Each version is

given a distinguishing version number. If the Library specifies a version number of this License which applies to it and "any later version", you have the option of following the terms and conditions either of that version or of any later version published by the Free Software Foundation. If the Library does not specify a license version number, you may choose any version ever published by the Free Software Foundation.

14. If you wish to incorporate parts of the Library into other free programs whose distribution conditions are incompatible with these, write to the author to ask for permission. For software which is copyrighted by the Free Software Foundation, write to the Free Software Foundation; we sometimes make exceptions for this. Our decision will be guided by the two goals of preserving the free status of all derivatives of our free software and of promoting the sharing and reuse of software generally.

15. The warranty disclaimer contained in Sections 11 and 12 of the preceding GPL License is incorporated herein.

Table of Contents

- About this Guide11
 - Audience 11
 - Other Sources of Information 11
 - Fortinet Publications 11
 - Website Resources 11
 - External References 12
 - Typographic Conventions 12
 - Contacting Fortinet 12
 - Customer Services and Support 13
- Access Points15
 - AP1000i..... 16
 - AP1000e 17
- Installing AP1000i19
 - Safety Precautions 19
 - Best Practices for a Mixed Network 19
 - Unpack the AP1000i 20
 - Power Requirements..... 21
 - Additional Equipment 21
 - Installing AP1000i 22
 - Select a Location 22

Install the Access Point	22
Restoring AP1000i Settings	38
Check AP1000i LEDs	39
Where to Go From Here	41
Installing AP1000e	43
Safety Precautions	43
Best Practices for a Mixed Network	44
Unpack the AP1000e	45
Power Requirements.	45
Additional Equipment	45
Installing AP1000e	46
Select a Location	46
Install the Access Point	46
Restoring AP1000e Settings.	53
Check AP1000e LEDs	54
Where to Go From Here	55
Installing AP1014i	57
Safety Precautions	57
Unpack the AP1014i	57
Power Requirements.	58
Additional Equipment	58
Installing AP1014i	59
Select a Location	59

Install the Access Point	59
Restoring AP1014i Settings	75
Check AP1014i LEDs	76
Where to Go From Here	77
Cautions and Warnings	79
Cautions	79
Warnings	81
Regulatory Information	85
USA	85
Underwriters Laboratories	85
FCC Radiation Exposure Statement	86
Radio Frequency Interference Requirements	86
Canada. Industry Canada (IC)	87
Europe—EU Declaration of Conformity and Restrictions	88
IEEE 802.11a Restrictions	91
EEE 802.11b/g Restrictions	91
Japan	91
Singapore	91
South Korea	92
Manufacturing Information	92
Distributed Antenna Systems (DAS)	92
Supported PoEs	93
Supported Power Over Ethernet Devices for Fortinet APs	93

1

About this Guide

This guide provides installation instructions for the Fortinet AP1000 model.

Audience

This guide is intended for anyone installing Fortinet Wireless LAN System Access Points (APs).

Other Sources of Information

Additional information is available in the following Fortinet publications, Web site, and external references.

Fortinet Publications

- *Fortinet System Director Release Notes*
- *Fortinet System Director Getting Started Guide*
- *Fortinet Controller Installation Guide*
- *Fortinet System Director Command Reference*
- *Fortinet System Director Configuration Guide*

Website Resources

For the first 90 days after you buy a Fortinet controller, you have access to online support. If you have a support contract, you have access for the length of the contract. See this web site for information such as:

- *Fortinet System Director Release Notes*
- Knowledge Base (Q&A)
- Downloads

- Open a ticket or check an existing one
- Customer Discussion Forum

The URL is: <http://support.merunetworks.com>

External References

- Stevens, W. R. 1994. TCP/IP Illustrated, Volume 1, The Protocols. Addison-Wesley, Reading, Mass.
- Gast, M.S. 2002. 802.11 Wireless Networks, The Definitive Guide. O'Reilly and Associates, Sebastopol, Calif.

Typographic Conventions

This document uses the following typographic conventions to help you locate and identify information:



Provides extra information, tips, and hints regarding the topic



Identifies important information about actions that could result in damage to or loss of data, or could cause the application to behave in unexpected ways.



Identifies critical information about actions that could result in equipment failure or bodily harm.

Contacting Fortinet

You can visit Fortinet on the Internet at this URL:

<http://www.merunetworks.com>

Customer Services and Support

For assistance, contact Fortinet Customer Services and Support 24 hours a day at +1-888-637-8952 or +1-408-215-5305. Email can be sent to support@merunetworks.com.

Fortinet Customer Services and Support provide end users and channel partners with the following:

- Telephone technical support
- Software update support
- Spare parts and repair service

RMA Procedures

Contact Fortinet Customer Services and Support for a Return Material Authorization (RMA) for any Fortinet equipment.

Please have the following available when making a call:

- Company and contact information
- Equipment model and serial numbers
- Fortinet software release and revision numbers (for example, 3.0.0-35)
- A description of the symptoms the problem is manifesting
- Network configuration

2

Access Points

Access Points contain radio devices that communicate with the Controller and form the wireless LAN (WLAN). The Controller and Access Points connect to the site's wired LAN through wired switches. Wireless clients associate with the Access Points as they roam throughout the WLAN. As such, they are an extension of the wired LAN, providing the wireless benefits of client mobility, enhanced access, and dynamic network configuration.

Figure 1: *Wireless LAN Connected to Network*

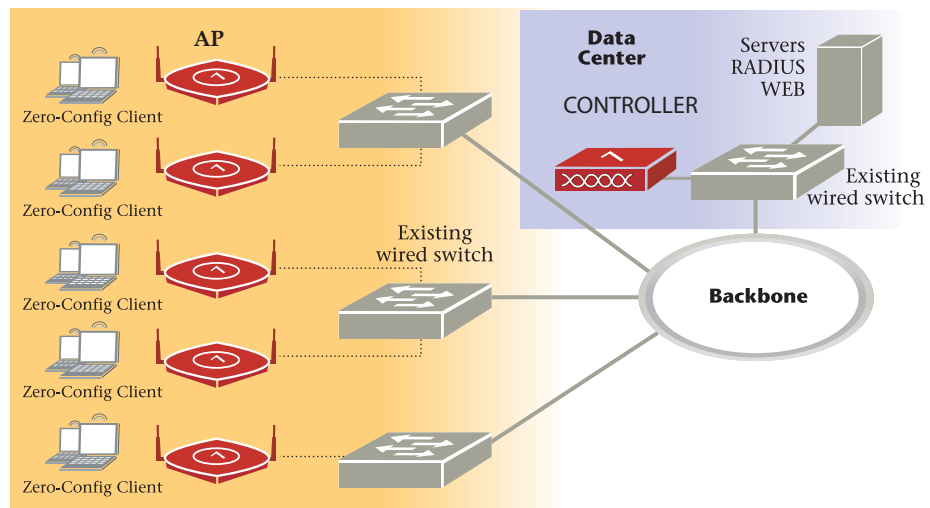

AP1000i

The AP1000i Access Point is an internal-antenna AP with either one or two dual-band 802.11n radios, 2x2 MIMO and internal antennas.

Model	Configuration
AP1014i	One single-band 802.11n radio with 2x2 MIMO, internal antennas, and four wired ethernet ports.
AP1010i	One single-band 802.11n radio with 2x2 MIMO and internal antennas
AP1020i	Two dual-band 802.11n radios with 2x2 MIMO and internal antennas

Features for the AP1000i include:

- Internal antennas
- 802.11n support with channel bonding in both 2.4GHz and 5GHz frequency bands. Channel bonding combines two 20MHz channels into a single 40 MHz channel for increased throughput.
- Plug and Play deployment using centralized controller platforms
- Multi-layered security including standard WPA2 features such as automatic traffic inspection
- Standard 802.3af PoE support and support for many 802.3at services
- Air Traffic Control technology for 802.11n devices and legacy a/b/g devices

Figure 2: *AP1000i*

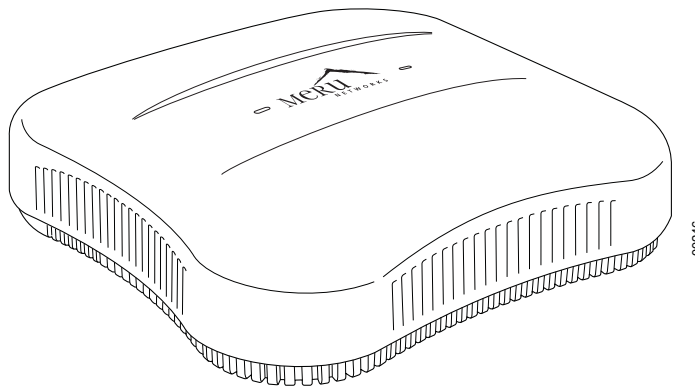

AP1000e

The AP1000ie Access Point is an external-antenna AP with either one or two dual-band 802.11n radios, 2x2 MIMO and external antennas.

Model	Configuration
AP1010e	One single-band 802.11n radio with 2x2 MIMO and external antennas
AP1020e	Two dual-band 802.11n radios with 2x2 MIMO and external antennas

Features for the AP1000e include:

- External antennas
- 802.11n support with channel bonding in both 2.4GHz and 5GHz frequency bands. Channel bonding combines two 20MHz channels into a single 40 MHz channel for increased throughput.
- Plug and Play deployment using centralized controller platforms
- Multi-layered security including standard WPA2 features such as automatic traffic inspection
- Standard 802.3af PoE support and support for many 802.3at services
- Air Traffic Control technology for 802.11n devices and legacy a/b/g devices

Figure 3: *AP1020e*

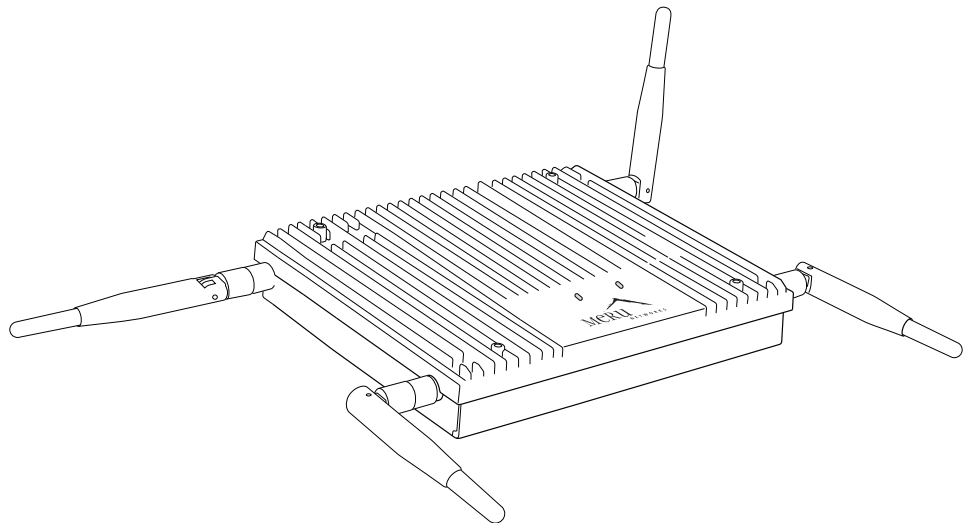

3

Installing AP1000i

AP1000i is supported by System Director versions 4.1 and greater. This chapter describes how to install and configure an AP1000i. It contains the following sections:

- *“Safety Precautions” on page 19*
- *“Best Practices for a Mixed Network” on page 19*
- *“Unpack the AP1000i” on page 20*
- *“Unpack the AP1000i” on page 20*
- *“Power Requirements” on page 21*
- *“Additional Equipment” on page 21*
- *“Installing AP1000i” on page 22*
- *“Restoring AP1000i Settings” on page 38*
- *“Check AP1000i LEDs” on page 39*
- *“Where to Go From Here” on page 41*

Safety Precautions

IMPORTANT—Read and follow the regulatory instructions in Appendix B before installing and operating this product.

The AP1000i is only intended for installation in Environment A as defined in IEEE 802.3af. All directly interconnected equipment (e.g., equipment sharing an electrical source) must be contained within the same building, including the interconnected equipment's associated LAN connection.

Best Practices for a Mixed Network

Read this section if you have both AP1000i and AP300 active simultaneously on the same network. The following best practices should be followed to get optimal performance from such a mixed network.

- Care must be taken when deploying different AP types in the same physical area.
- STP (Spanning Tree Protocol) must be disabled on the switch for AP1020.
- If AP1000i and AP300 have overlapping coverage, you have two options: deploy them on separate channels or make sure the ESS profiles on both AP types are unique. The chart below shows two ESS scenarios, one supported, one not supported.

Supported ESS Scenario	AP1000i Configuration	AP300 Configuration
Two Unique ESS profiles	ESS Profile name in controller is UniqueName1	ESS Profile name in controller is UniqueName2
AP1000i and AP320i SSID string over the air	Meru	Meru

Unsupported ESS Scenario	AP1000i Configuration	AP300 Configuration
Same ESS profiles	ESS Profile name in controller is same name	ESS Profile name in controller is same name
AP1000i and AP320i SSID string over the air	Meru	Meru

Assumptions for the above best practices include:

- AP1000 models have Virtual Port disabled (recommended).
- AP300 models have Virtual Port enabled (recommended).
- AP1000is and AP300s are on the same channel. (AP1000i and AP320i could also be on different channels.)
- AP1000is and AP320i are on the same controller. (AP1000i and AP320i could also be on different controllers as long as each controller has a unique controller index.)

Unpack the AP1000i

AP1000i series uses both the dual radio (AP1020) and single radio (AP1010) models. Confirm that the shipping box contains the following:

- AP1000i ships with built-in ceiling mount clips. Each radio has two built-in antennas, so AP1010 has two built-in antennas and AP1020 has four built-in antennas.
- Locking tool for ceiling mount locking. You can see a drawing of this in [Figure 5 on page 23](#).



If you want to lock AP1000i to the wall, you need the optional kit MNT-WMKIT-01.

Power Requirements

Radios on an AP1000i use 2x2 MIMO configuration. To power an AP1000i, use either an 802.3af or 802.3at PoE cable; either one works automatically with no configuration required. For a list of supported PoEs, see the appendix [“Supported Power Over Ethernet Devices for Fortinet APs” on page 93](#)

Additional Equipment

The following AP1000i mounting options require the listed additional equipment:

Installation Type	Additional Equipment
Ceiling mounting on a suspended ceiling with or without locking	<ul style="list-style-type: none"> • Either an 802.3af or 802.3at PoE cable
Wall mounting	<ul style="list-style-type: none"> • Either an 802.3af or 802.3at PoE cable • Wall mount screws – Recommend #6, #8 (M3, M3.5)
Wall mounting with locking	<ul style="list-style-type: none"> • Either an 802.3af or 802.3at PoE cable • Locking Kit 840-00052 MNT-WMKIT-01
Ceiling mounting with lowered tiles	<ul style="list-style-type: none"> • Either an 802.3af or 802.3at PoE cable • Recessed Ceiling Mount Kit 840-0005x MNT-SCRM-KIT-03 or -04

Installing AP1000i

Select a Location

All AP1000i interconnected equipment must be contained within the same building, including the interconnected equipment's associated LAN connection. Ceiling mounting is recommended but wall mounting is also supported. In addition, the AP1000i should be mounted in a location that meets the following conditions:

- Relatively unobstructed access to the clients the AP serves. Select a location with minimal physical obstructions between the AP and the wireless clients. We recommend planning for about 20 data clients per radio (or per interference region) if you plan to use Virtual Port. This is the recommendation for a data-only installation. Refer to the Fortinet Deployment Guides on the support site for more information.
- In an office with cubicles, mount the APs below a hanging ceiling or on the wall near the ceiling to provide the least obstructed communications path.
- On a wall, orient the AP1000i horizontally so that you can read the Fortinet logo without tilting your head at 90 degrees - this orientation provides optimum MIMO performance.
- AP1000i is designed to provide 180 degree directional coverage as illustrated below. Plan placement with this pattern in mind.

Figure 4: Coverage Pattern for AP1000i When Ceiling Mounted

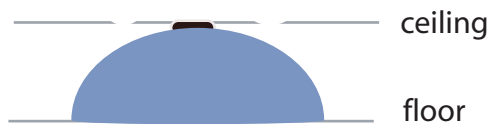

- If you install AP1000i on a pole, keep in mind that coverage will be 180 degrees; the pattern shown above would be directed sideways. We do not recommend mounting two AP1000is back to back on a pole to achieve 360 degree coverage, however, because the two units could interfere with each other.

Install the Access Point

You can mount AP1000i in any of the following ways:

- [“Mount AP1000i Below a Suspended Ceiling” on page 23](#)
- [“Mount AP1000i on a Dropped Ceiling Bevel Tile” on page 25](#)
- [“Mount AP1000i on an Interlude T-Bar” on page 28](#)
- [“Mount AP1000i on a Wall” on page 31](#)
- [“Mount AP1000i on a Wall Using the Optional Locking Kit” on page 33](#)

- “Set AP1000i on a Shelf” on page 34
- “Mount AP1000i Above a Suspended Ceiling” on page 35

Mount AP1000i Below a Suspended Ceiling

AP1000i ships ready to mount below a suspended ceiling; the built-in clips snap onto a ceiling rail. To mount an AP1000i below a suspended ceiling, follow these steps:

1. Remove the ceiling tiles at the location the AP will be mounted.
2. Be sure that AP1000i is not locked by inserting the locking key into the Unlock mechanism as shown in [Figure 5 on page 23](#) below.

Figure 5: Unlock AP1000i

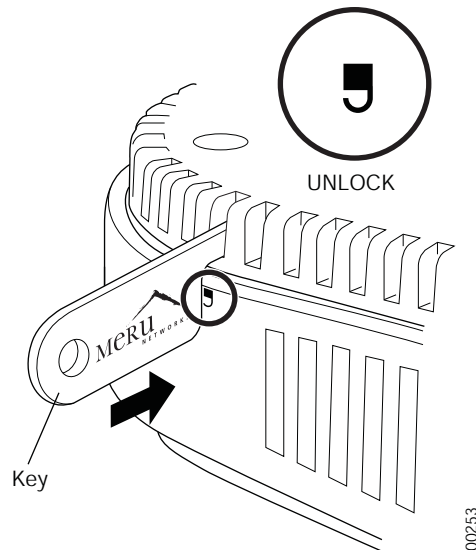

3. Align the ceiling t-bar with the AP1000i slots indicated in [Figure 6 on page 24](#) below.

Figure 6: *Install AP1000i Below a Suspended Ceiling*

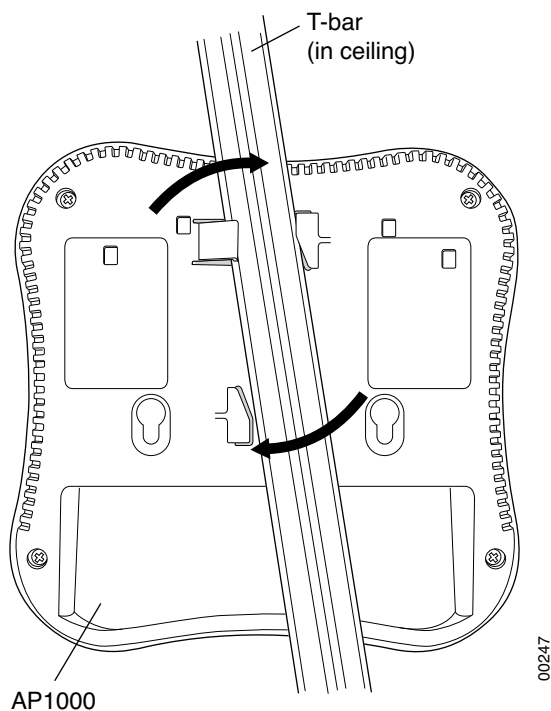

4. Press down on the tab indicated in [Figure 6 on page 24](#) above and rotate the AP1000i into place.
5. Connect one end of the CAT5 (or greater) Ethernet cable with PoE to the 100/1000 Ethernet connector shown in [Figure 7 on page 25](#) below.



Be sure to connect the Ethernet cable to the Ethernet port. The cable can mistakenly be plugged into the Console port; if you do this, the AP won't power up.

Figure 7: AP1000i Ethernet Port

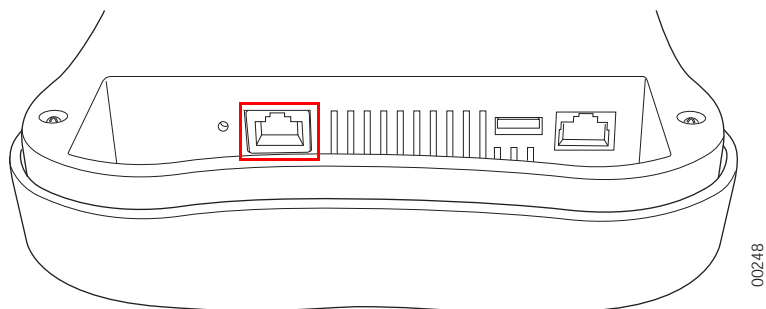

6. If you want to lock AP1000i in place, use the supplied locking tool to press the AP1000i locking mechanism shown in [Figure 8 on page 25](#).

Figure 8: Optionally lock AP1000i

AP1000 (mounted on ceiling)

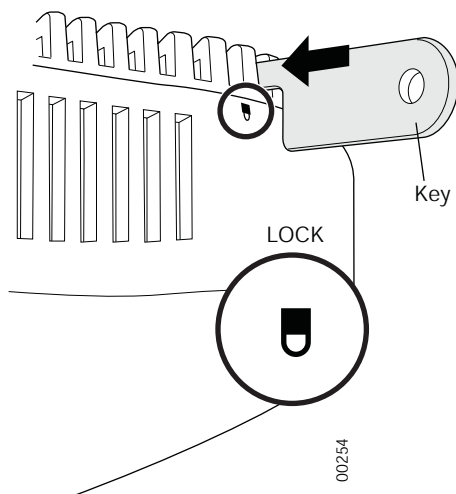

7. To unlock AP1000i, press the unlocking mechanism on the opposite side of AP1000i see [Figure 5 on page 23](#).

Mount AP1000i on a Dropped Ceiling Bevel Tile

The mounting procedure for a ceiling that has recessed supports and lowered tiles is similar to that of mounting on a suspended ceiling. However, this procedure requires a specialized mounting bracket (ACC-MNT-SCRMKIT-03), as shown in [Figure 9 on page 26](#).

Figure 9: *Dropped Bevel Tile Mounting Bracket*

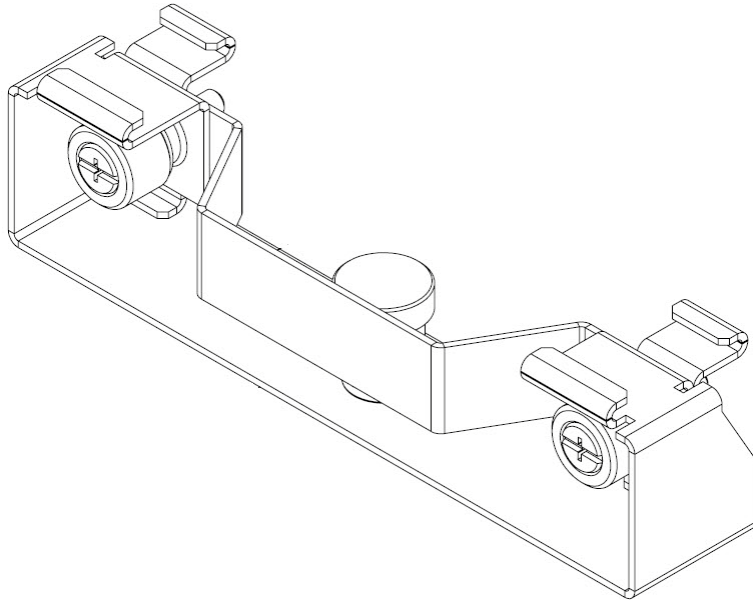

1. Remove the ceiling tile alongside which the AP will be mounted.
2. Be sure that AP1000i is not locked by inserting the locking key into the Unlock mechanism as shown in [Figure 10 on page 27](#) below.

Figure 10: Unlock AP1000i

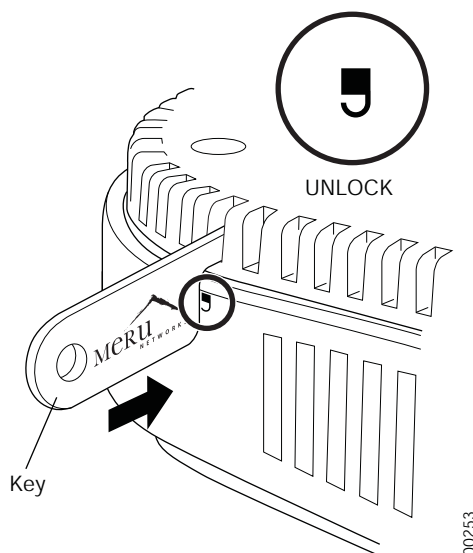

3. Align the mounting bracket with the AP1000i slots used for the ceiling t-bar in the previous section (as shown in [Figure 6 on page 24](#)).
4. Press down on the tab indicated in [Figure 6 on page 24](#) and rotate the AP1000i into place.
5. Push down on the thumbscrews provided on the mounting bracket and clip it to the ceiling bar that will support the AP.
6. Tighten the screws to ensure that the mechanism stays locked in place.
7. Connect one end of the CAT5 (or greater) Ethernet cable with PoE to the 100/1000 Ethernet connector shown in [Figure 11 on page 28](#) below.



Be sure to connect the Ethernet cable to the Ethernet port. The cable can mistakenly be plugged into the Console port; if you do this, the AP won't power up.

Figure 11: AP1000i Ethernet Port

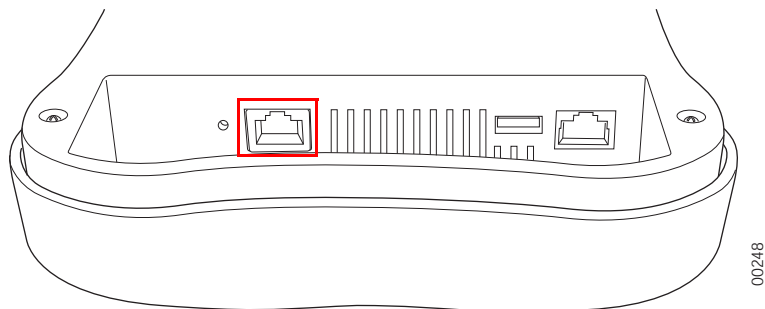

8. If you want to lock AP1000i in place, use the supplied locking tool to press the AP1000i locking mechanism shown in [Figure 12 on page 28](#).

Figure 12: Optionally lock AP1000i

AP1000 (mounted on ceiling)

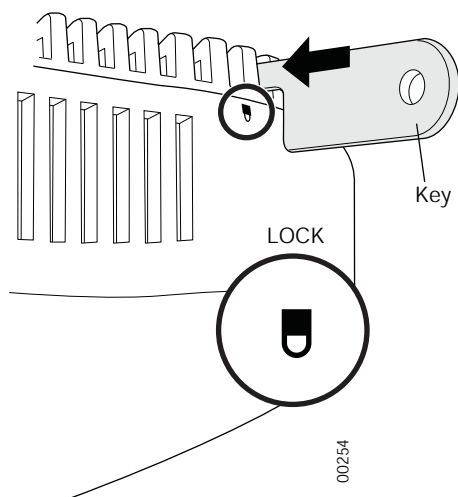

9. To unlock AP1000i, press the unlocking mechanism on the opposite side of AP1000i see [Figure 10 on page 27](#).

Mount AP1000i on an Interlude T-Bar

The mounting procedure for a ceiling that has interlude T-Bar supports is similar to that of mounting on a suspended ceiling. However, this procedure requires a specialized mounting bracket (ACC-MNT-SCRMKIT-04), as depicted in [Figure 13 on page 29](#).

Figure 13: T-Bar Mounting Bracket

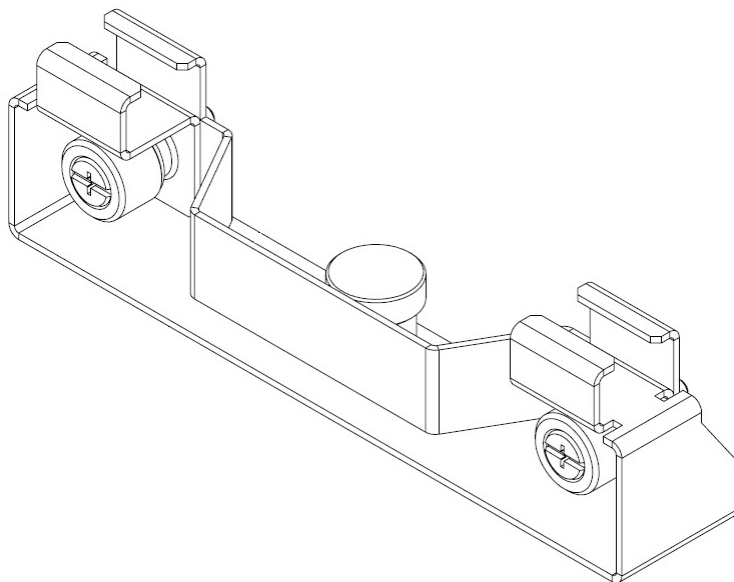

1. Remove the ceiling tile alongside which the AP will be mounted.
2. Be sure that AP1000i is not locked by inserting the locking key into the Unlock mechanism as shown in [Figure 14 on page 29](#) below.

Figure 14: Unlock AP1000i

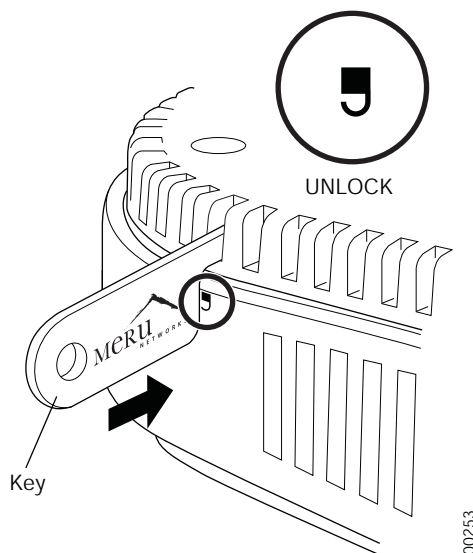

00253

3. Align the mounting bracket with the AP1000i slots used for the ceiling t-bar in the previous section (as shown in [Figure 6 on page 24](#)).
4. Press down on the tab indicated in [Figure 6 on page 24](#) and rotate the AP1000i into place.
5. Push down on the thumbscrews provided on the mounting bracket and clip it to the ceiling bar that will support the AP.
6. Tighten the screws to ensure that the mechanism stays locked in place.
7. Connect one end of the CAT5 (or greater) Ethernet cable with PoE to the 100/1000 Ethernet connector shown in [Figure 15 on page 30](#) below.



Be sure to connect the Ethernet cable to the Ethernet port. The cable can mistakenly be plugged into the Console port; if you do this, the AP won't power up.

Figure 15: AP1000i Ethernet Port

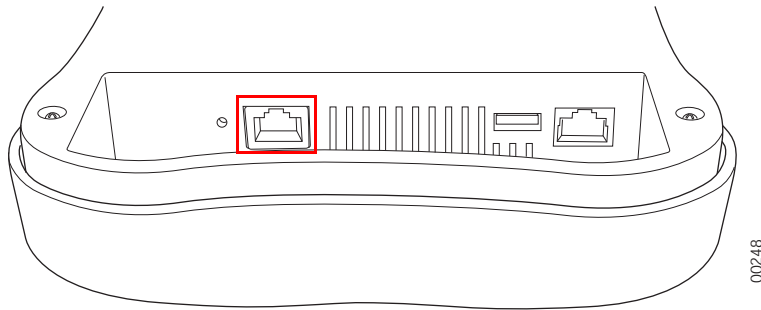

8. If you want to lock AP1000i in place, use the supplied locking tool to press the AP1000i locking mechanism shown in [Figure 16 on page 31](#).

Figure 16: Optionally lock AP1000i

AP1000 (mounted on ceiling)

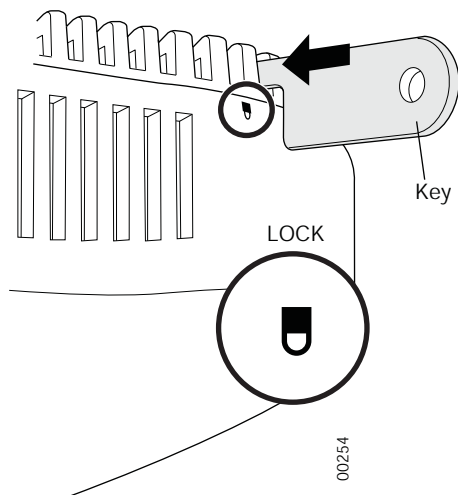

9. To unlock AP1000i, press the unlocking mechanism on the opposite side of AP1000i see [Figure 10 on page 27](#).

Mount AP1000i on a Wall

The AP1000i attaches directly to the wall. To mount an AP1000i on sheet rock or wall studs, follow these steps:

1. Attach two appropriate screws (see [“Additional Equipment” on page 21](#) for screw information) to the wall 3 inches apart (76mm) as shown below ([Figure 17 on page 32](#)).

Figure 17: AP1000i Wall Bracket

Wall mount with screws.

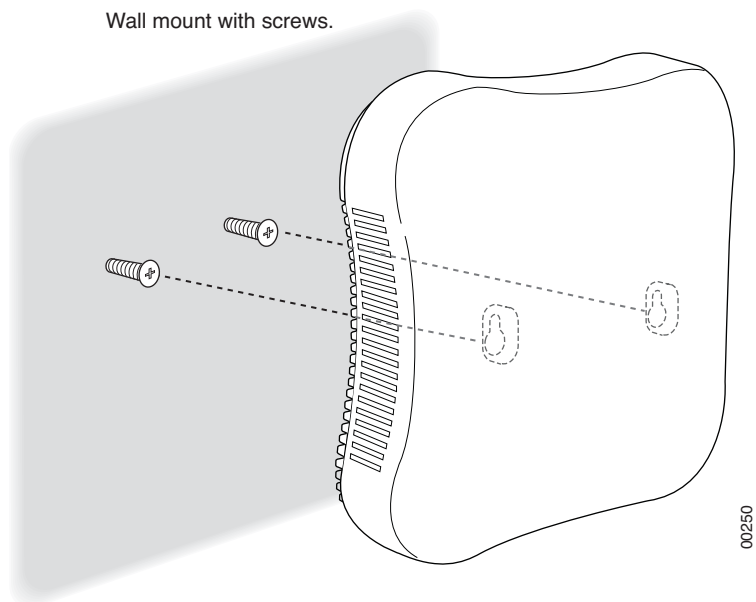

2. Attach the PoE Ethernet cable to the Ethernet port shown in [Figure 18 on page 32](#).



Be sure to connect the Ethernet cable to the Ethernet port. The cable can mistakenly be plugged into the Console port; if you do this, the AP won't power up.

Figure 18: AP1000i Ethernet Port

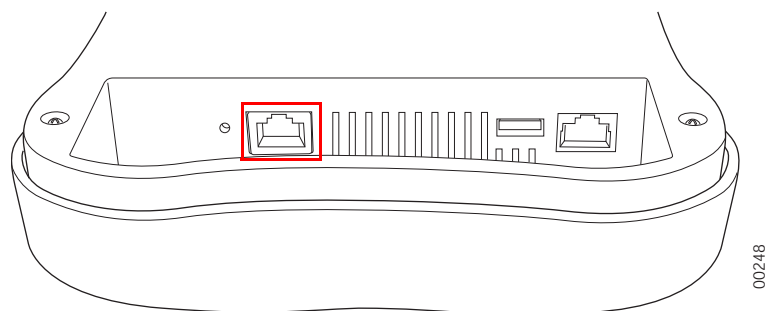

3. Align the screws on the wall with the keyholes on the AP and slide the unit down slightly. See [Figure 17 on page 32](#).

Mount AP1000i on a Wall Using the Optional Locking Kit

The AP1000i locking wall mount kit (840-00052 MNT-WMKIT-01) contains a wall bracket, screws, and a locking key. To mount an AP1000i on sheetrock or wall studs with this kit, follow these steps:

1. Attach AP1000i to the bracket as shown in [Figure 19 on page 33](#).

Figure 19: Attach AP1000i to Wall Bracket

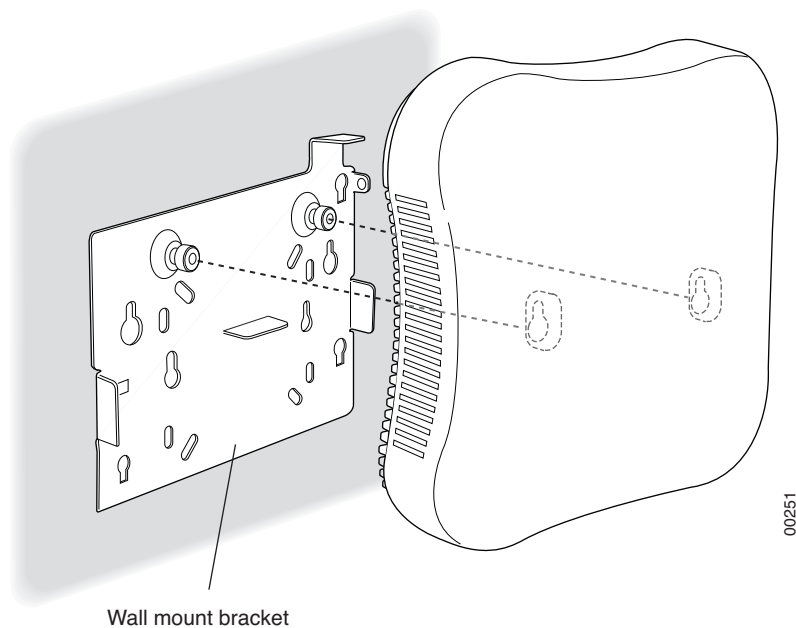

2. Insert the locking key and apply a small suitcase lock as shown in [Figure 20 on page 34](#).

Figure 20: AP1000i Locked to a Wall

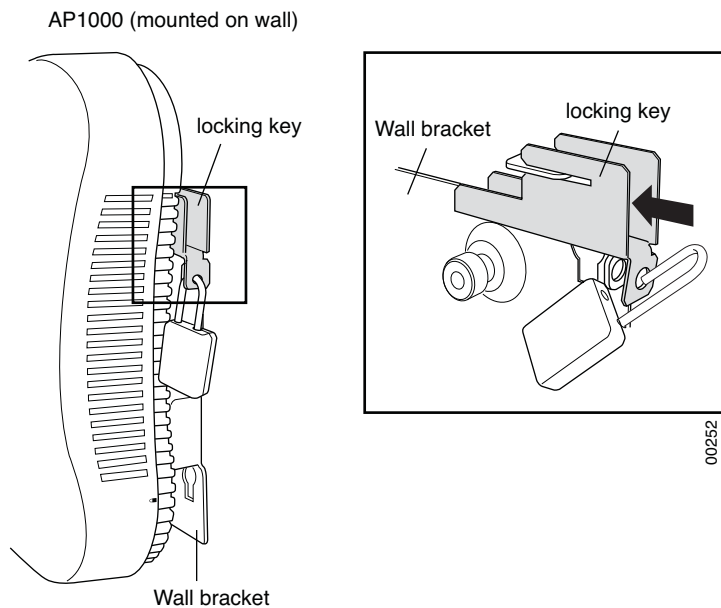

Set AP1000i on a Shelf

Set AP1000i on any horizontal surface and then connect a PoE Ethernet cable.



Be sure to connect the Ethernet cable to the Ethernet port. The cable can mistakenly be plugged into the Console port; if you do this, the AP won't power up.

Figure 21: AP1000i Ethernet Port on the Left

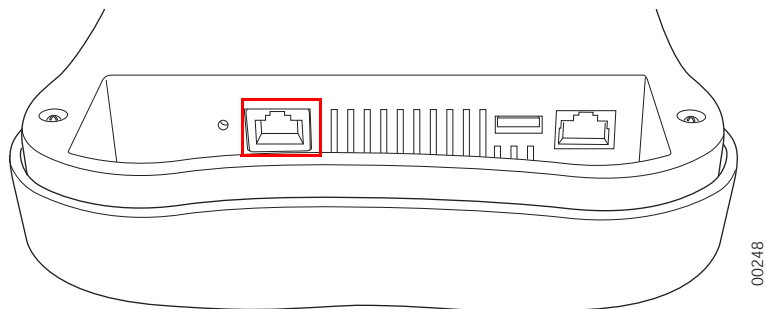

Mount AP1000i Above a Suspended Ceiling



AP1000i is not plenum-rated and should only be mounted above ceilings in non-plenum air space, such as a return airflow for air conditioning.

Use the optional T-bar box hanger mounting kit to mount AP1000i above suspended ceiling T-rails. The installation attaches the T-bar box hanger to the ceiling rails and then the AP1000i attaches to the T-bar box hanger. Note that AP1000i mounted above the ceiling has about 2-3 dBm less RF coverage than AP1000i mounted under the ceiling.

You may need to modify thicker tiles to support this installation.



When installed in air-handling spaces, such as above a suspended ceiling, power the AP1000i only with a PoE, not a power supply.

To mount an AP1000i above the ceiling with the optional T-bar kit, follow these steps:

1. Determine the location on the ceiling rails where the AP will be mounted and remove the ceiling tile.
2. Unpack the T-bar hanger kit.
3. Unlock the AP using the provided key.

Figure 22: Unlock AP1000i

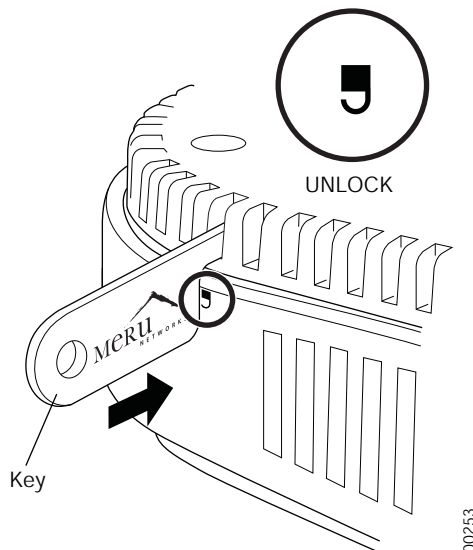

00253

4. Attach the mounting bar (depicted in [Figure 23 on page 36](#)) to the mounting brace (which looks like a small handle) with the crossbar of the mounting kit sandwiched between them. See [Figure 24 on page 36](#).

Figure 23: Mounting Bar



Figure 24: Assembled Mounting Bracket

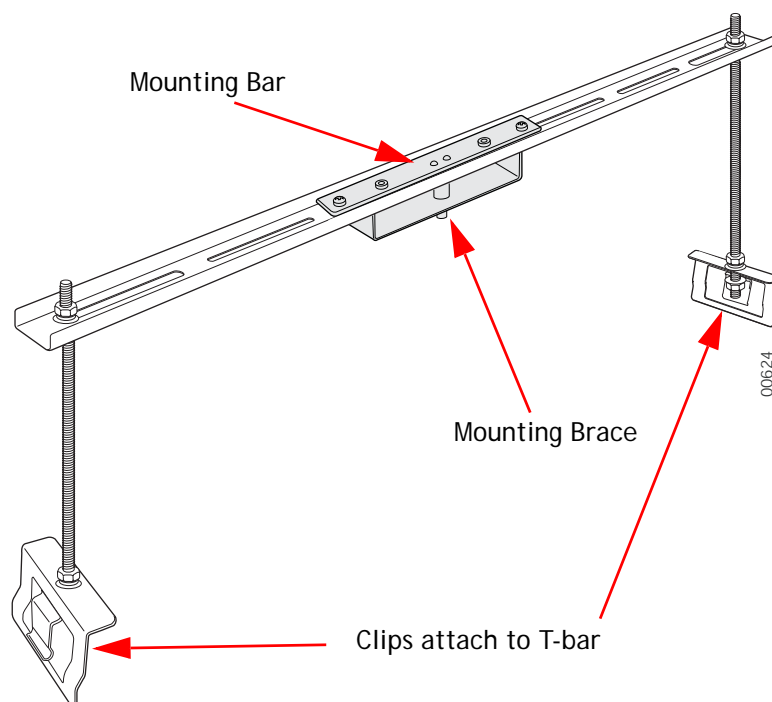

5. Gently press the underside of the AP1000i against the mounting brace and rotate it into place until the locking mechanism clicks. Note that this is essentially the same process as depicted in [Figure 6 on page 24](#).
6. Lock the AP1000i in place using the provided key.

Figure 25: Lock AP1000i

AP1000 (mounted on ceiling)

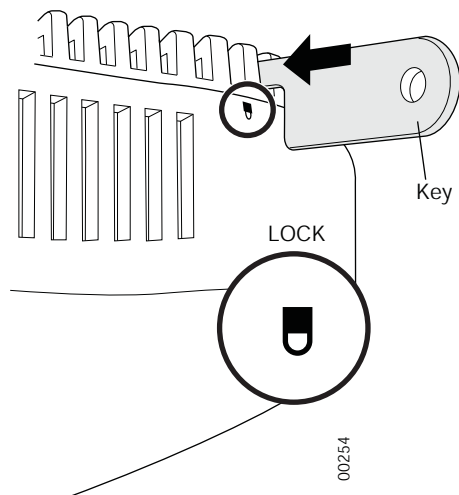

7. Attach the legs for the mounting kit to the T-Bars in the ceiling by sliding the clips down onto each respective bar.
8. Remove the top nut from each leg.
9. Lower the crossbar (with the AP attached) onto the legs and screw the nuts back on top of the bar.
10. Connect one end of the PoE Ethernet cable to the Ethernet connector on the AP.



Be sure to connect the Ethernet cable to the Ethernet port; the cable can mistakenly be plugged into the Console port. If you do this, the AP won't power up.



Use a shielded Cat 5e (or greater) Ethernet cable in order to comply with international electromagnetic emissions limits.

Check that the AP1000i is operating correctly before replacing the ceiling tile to the ceiling. Verify correct operation using the LEDs, as shown in [“Check AP1000i LEDs” on page 39](#).

Restoring AP1000i Settings

Trigger the Restore mechanism to return the AP1000i to the factory default settings. This overrides any changes that have been made from the controllers. Note that this restore mechanism differs from the ones on the other APs. Instead of a straight paper clip, you need to use a paper clip bent at a right angle to push the mechanism trigger located on the inside as indicated in the Figure below. Access it through the small hole with the bent paper clip. Press and hold the button for 10 seconds. After 10 seconds, the AP reboots and comes back up with default settings.

Figure 26: AP1000i Restore Button

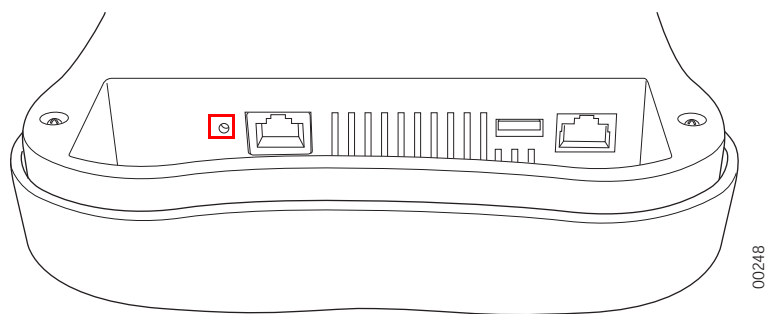

Check AP1000i LEDs

Figure 27: *AP1000i Status LEDs*

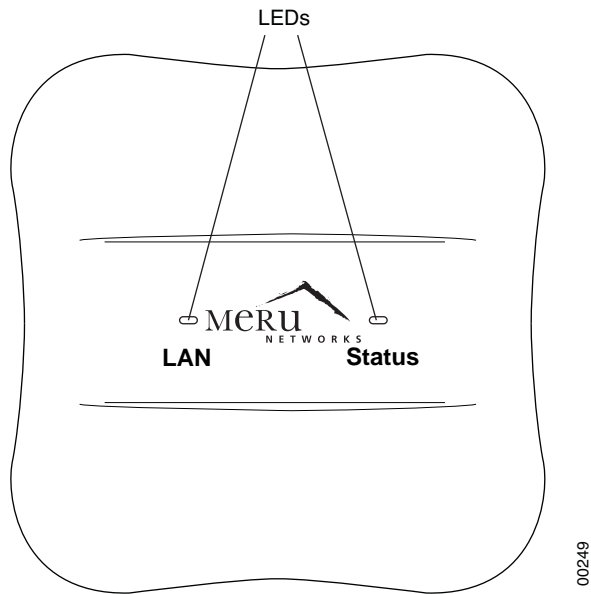

LED	Color	State
Status (right LED)	off	AP is off - either there is no power or the LEDs are set to Off on the controller. Check the LED setting on the controller by clicking Configuration > Devices > AP , selecting the AP and then checking the setting for LED Mode.
	cyan	AP is booting stage 1.
	green blinking	AP is booting stage 2.
	green/white alternating	AP is discovering the controller.
	green/blue alternating	AP is downloading a configuration from the controller.
	slow blue blinking	AP is online and enabled.
	rapid blue blinking	AP is online and enabled and there is activity on one or both radios.
	red/yellow alternating	Some AP failure occurred; check the controller for more details about the alarm by clicking Monitor > Alarms > Pending Alarms .
LAN (left LED)	blue/yellow alternating	AP is online and enabled and one or both radios are either scanning or an admin has taken the radio(s) down.
	green	LAN link is up.
	green blinking	LAN link is up and some activity is taking place.
	red	Link has either failed or has been brought down.
	alternating green/orange	Link is experiencing receive errors.

The AP1000i has two LEDs, Status and LAN, as shown in [Figure 27 on page 39](#). If you want to change the appearance of the LEDs, follow these steps:

1. From the controller, click **Configuration > Devices > AP**, and then select the AP.
2. Select one of these settings for the LED Mode setting:
 - **Normal:** LEDs are as described above
 - **Blink:** Sets all LEDs flashing; this is useful to locate an AP
 - **Dark:** Turns off all LEDs
3. Click **OK**.

Where to Go From Here

Now that the AP1000i is installed, go to the ***Meru System Director Getting Started Guide*** for instructions on initializing the hardware. Return to this chapter to check the status of the LEDs once the WLAN is operational; note that LED status is configurable, so the chart above may not apply to APs whose status was reconfigured.

4

Installing AP1000e

AP1000e is supported by System Director versions 5.1 and greater. This chapter describes how to install and configure an AP1000e. It contains the following sections:

- [“Safety Precautions” on page 43](#)
- [“Best Practices for a Mixed Network” on page 44](#)
- [“Unpack the AP1000e” on page 45](#)
- [“Power Requirements” on page 45](#)
- [“Additional Equipment” on page 45](#)
- [“Installing AP1000e” on page 46](#)
- [“Restoring AP1000e Settings” on page 53](#)
- [“Check AP1000e LEDs” on page 54](#)
- [“Where to Go From Here” on page 55](#)

Safety Precautions

IMPORTANT—Read and follow the regulatory instructions in Appendix B before installing and operating this product.



This product is intended to be supplied by a UL Listed power supply marked Class 2 or LPS and rated minimum 5Vdc, 3A.

The AP1000e is only intended for installation in Environment A as defined in IEEE 802.3af. All directly interconnected equipment (e.g., equipment sharing an electrical source) must be contained within the same building, including the interconnected equipment's associated LAN connection.

Best Practices for a Mixed Network

Read this section if you have both AP1000e and AP300 active simultaneously on the same network. The following best practices should be followed to get optimal performance from such a mixed network.

- Care must be taken when deploying different AP types in the same physical area.
- If AP1000e and AP300 have overlapping coverage, you have two options: deploy them on separate channels or make sure the ESS profiles on both AP types are unique. The chart below shows two ESS scenarios, one supported, one not supported.

Supported ESS Scenario	AP1000e Configuration	AP300 Configuration
Two Unique ESS profiles	ESS Profile name in controller is UniqueName1	ESS Profile name in controller is UniqueName2
AP1000e and AP320i SSID string over the air	Meru	Meru

Unsupported ESS Scenario	AP1000e Configuration	AP300 Configuration
Same ESS profiles	ESS Profile name in controller is same name	ESS Profile name in controller is same name
AP1000e and AP320i SSID string over the air	Meru	Meru

Assumptions for the above best practices include:

- AP1000 models have Virtual Port disabled (recommended).
- AP300 models have Virtual Port enabled (recommended).
- AP1000es and AP300s are on the same channel. (AP1000e and AP320i could also be on different channels.)
- AP1000es and AP320i are on the same controller. (AP1000e and AP320i could also be on different controllers as long as each controller has a unique controller index.)

Unpack the AP1000e

AP1000e series employs a dual radio model—the AP1020e—which includes two antennas for each radio. Confirm that the shipping box contains the following:

- AP1000e
- Four (4) omnidirectional antennas
- Wall mount bracket
- Three (3) large screws (for attaching to the wall mount bracket)
- Four (4) rubber feet (for use when deploying on a horizontal surface)

Power Requirements

Radios on an AP1000e use 2x2 MIMO configuration. To power an AP1000e, use either an 802.3af or 802.3at PoE cable; either one works automatically with no configuration required. For a list of supported PoEs, see the appendix [“Supported Power Over Ethernet Devices for Fortinet APs” on page 93](#)

Additional Equipment

The following AP1000e mounting options require the listed additional equipment:

Installation Type	Additional Equipment
Ceiling mounting on a suspended ceiling	<ul style="list-style-type: none">• Either an 802.3af or 802.3at PoE cable
Wall mounting	<ul style="list-style-type: none">• Either an 802.3af or 802.3at PoE cable• Wall mount screws – Recommend #6, #8 (M3, M3.5)
Ceiling mounting with lowered tiles	<ul style="list-style-type: none">• Either an 802.3af or 802.3at PoE cable• Recessed Ceiling Mount Kit 840-0005x MNT-SCRM-KIT-03 or -04

Installing AP1000e

Select a Location

All AP1000e interconnected equipment must be contained within the same building, including the interconnected equipment's associated LAN connection. Ceiling mounting is recommended but wall mounting is also supported. In addition, the AP1000e should be mounted in a location that meets the following conditions:

- Relatively unobstructed access to the clients the AP serves. Select a location with minimal physical obstructions between the AP and the wireless clients. We recommend planning for about 20 data clients per radio (or per interference region) if you plan to use Virtual Port. This is the recommendation for a data-only installation. Refer to the Fortinet Deployment Guides on the support site for more information.
- In an office with cubicles, mount the APs below a hanging ceiling or on the wall near the ceiling to provide the least obstructed communications path.
- On a wall, orient the AP1000e horizontally so that you can read the Meru logo without tilting your head at 90 degrees - this orientation provides optimum MIMO performance.

Install the Access Point

You can mount AP1000e in any of the following ways:

- *[“Mount AP1000e Below a Suspended Ceiling” on page 46](#)*
- *[“Mount AP1000e on a Dropped Ceiling Bevel Tile” on page 48](#)*
- *[“Mount AP1000e on an Interlude T-Bar” on page 49](#)*
- *[“Mount AP1000e on a Wall” on page 50](#)*
- *[“Mount AP1000e Above a Suspended Ceiling” on page 51](#)*

Mount AP1000e Below a Suspended Ceiling

AP1000e ships ready to mount below a suspended ceiling; the built-in clips snap onto a ceiling rail. To mount an AP1000e below a suspended ceiling, follow these steps:

1. Remove the ceiling tiles at the location the AP will be mounted.
2. Align the ceiling t-bar with the AP1000e slots indicated in [Figure 28 on page 47](#) below.

Figure 28: Install AP1000e Below a Suspended Ceiling

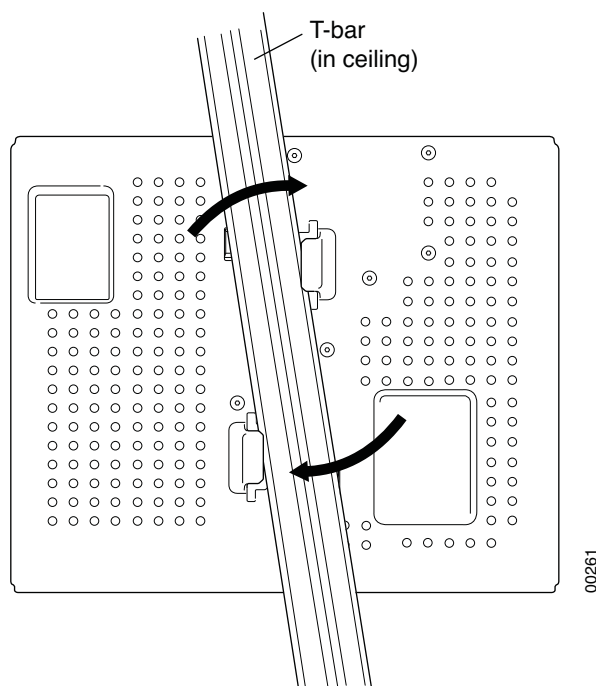

3. Press down on the tab indicated in [Figure 28 on page 47](#) above and rotate the AP1000e into place.
4. Connect one end of the CAT5 (or greater) Ethernet cable with PoE to the 100/1000 Ethernet connector shown in [Figure 29 on page 47](#) below.



Be sure to connect the Ethernet cable to the Ethernet port. The cable can mistakenly be plugged into the Console port; if you do this, the AP won't power up.

Figure 29: AP1000e Ethernet Port

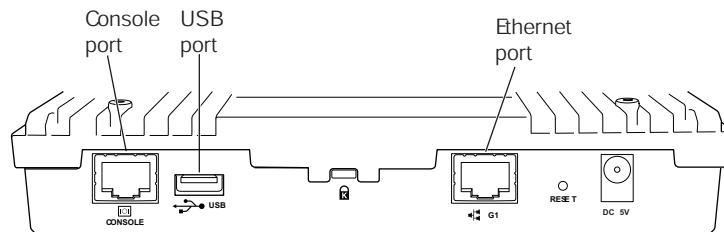

Mount AP1000e on a Dropped Ceiling Bevel Tile

The mounting procedure for a ceiling that has recessed supports and lowered tiles is similar to that of mounting on a suspended ceiling. However, this procedure requires a specialized mounting bracket (ACC-MNT-SCRMKIT-03), as shown in [Figure 30 on page 48](#).

Figure 30: *Dropped Bevel Tile Mounting Bracket*

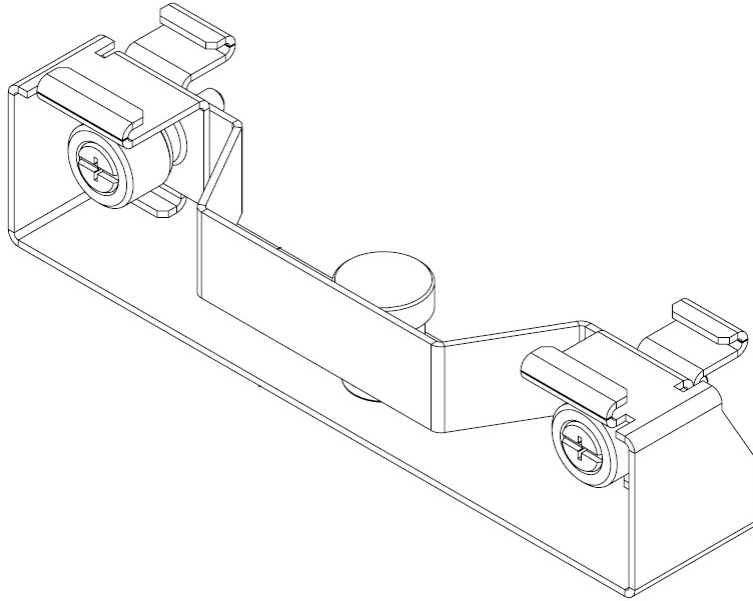

1. Remove the ceiling tile alongside which the AP will be mounted.
2. Align the mounting bracket with the AP1000e slots used for the ceiling t-bar in the previous section (as shown in [Figure 28 on page 47](#)).
3. Press down on the tab indicated in [Figure 28 on page 47](#) and rotate the AP1000e into place.
4. Push down on the thumbscrews provided on the mounting bracket and clip it to the ceiling bar that will support the AP.
5. Tighten the screws to ensure that the mechanism stays locked in place.
6. Connect one end of the CAT5 (or greater) Ethernet cable with PoE to the 100/1000 Ethernet connector shown in [Figure 31 on page 49](#) below.



Be sure to connect the Ethernet cable to the Ethernet port. The cable can mistakenly be plugged into the Console port; if you do this, the AP won't power up.

Figure 31: AP1000e Ethernet Port

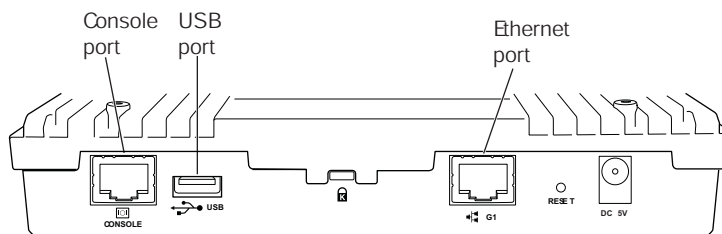

Mount AP1000e on an Interlude T-Bar

The mounting procedure for a ceiling that has interlude T-Bar supports is similar to that of mounting on a suspended ceiling. However, this procedure requires a specialized mounting bracket (ACC-MNT-SCRMKIT-04), as depicted in [Figure 32 on page 49](#).

Figure 32: T-Bar Mounting Bracket

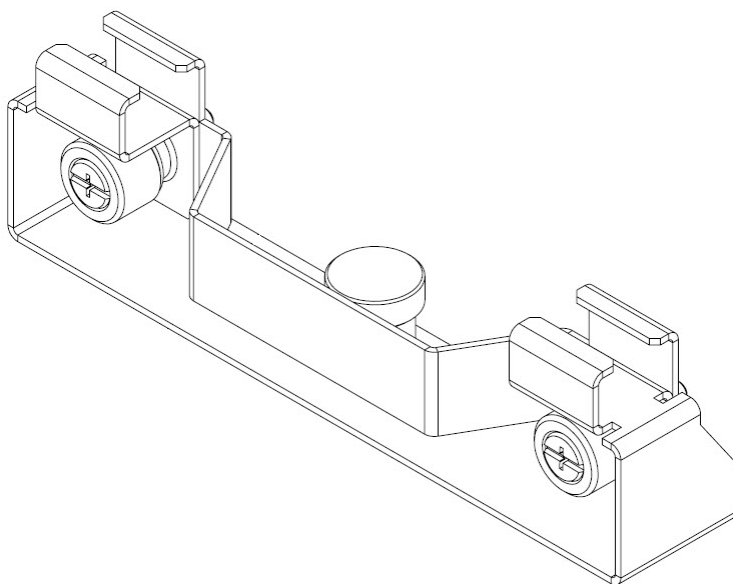

1. Remove the ceiling tile alongside which the AP will be mounted.
2. Align the mounting bracket with the AP1000e slots used for the ceiling t-bar in the previous section (as shown in [Figure 28 on page 47](#)).
3. Press down on the tab indicated in [Figure 28 on page 47](#) and rotate the AP1000e into place.
4. Push down on the thumbscrews provided on the mounting bracket and clip it to the ceiling bar that will support the AP.
5. Tighten the screws to ensure that the mechanism stays locked in place.

6. Connect one end of the CAT5 (or greater) Ethernet cable with PoE to the 100/1000 Ethernet connector shown in [Figure 33 on page 50](#) below.



Be sure to connect the Ethernet cable to the Ethernet port. The cable can mistakenly be plugged into the Console port; if you do this, the AP won't power up.

Figure 33: AP1000e Ethernet Port

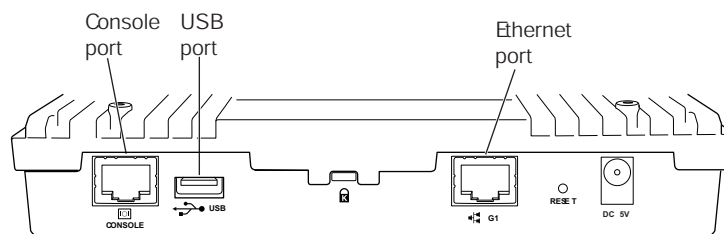

Mount AP1000e on a Wall

The AP1000e package includes a wall mount bracket that attaches directly to the wall. To mount an AP1000e on sheet rock or wall studs, follow these steps:

1. Using the supplied wall mount bracket as a guide, mark the four holes on the wall that will anchor the bracket in place. The four screws should be aligned to the four corners of the bracket.
2. Drill the holes as marked and attach the wall mount bracket with four screws.
3. Attach the three mounting screws supplied in the AP1000e package to the corresponding holes on the underside of the AP. The holes are indicated in the figure below, and are highlighted by hexagons on the AP itself.

Figure 34: AP1000e Mounting Screw Locations

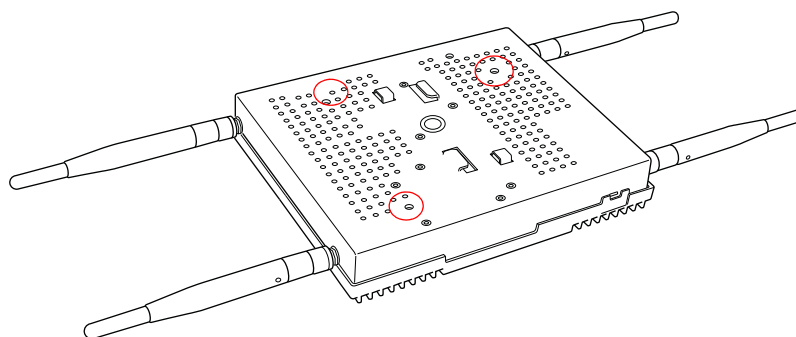

4. Align the mounting screws with their corresponding holes in the bracket and press the AP against the wall.

5. Slide the AP downwards until it locks into place. The plastic lever attached to the wall mount kit will click, locking the device.
6. Connect the antennas to the ports on the AP.
7. Attach the PoE Ethernet cable to the Ethernet port shown in [Figure 35 on page 51](#).



Be sure to connect the Ethernet cable to the Ethernet port. The cable can mistakenly be plugged into the Console port; if you do this, the AP won't power up.

Figure 35: AP1000e Ethernet Port

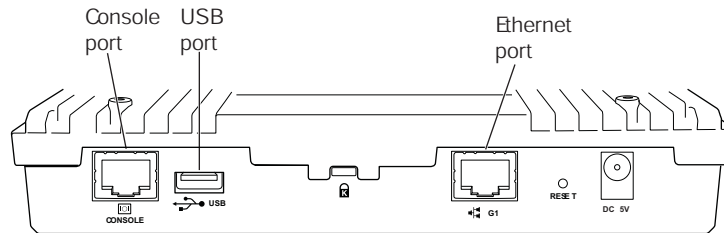

Mount AP1000e Above a Suspended Ceiling

Use the optional T-bar box hanger mounting kit to mount AP1000e above suspended ceiling T-rails. The installation attaches the T-bar box hanger to the ceiling rails and then the AP1000e attaches to the T-bar box hanger. Note that AP1000e mounted above the ceiling has about 2-3 dBm less RF coverage than AP1000e mounted under the ceiling.

You may need to modify thicker tiles to support this installation.



When installed in air-handling spaces, such as above a suspended ceiling, power the AP1000e only with a PoE, not a power supply.

To mount an AP1000e above the ceiling with the optional T-bar kit, follow these steps:

1. Determine the location on the ceiling rails where the AP will be mounted and remove the ceiling tile.
2. Unpack the T-bar hanger kit.
3. Attach the mounting bar (depicted in [Figure 36 on page 52](#)) to the mounting brace (which looks like a small handle) with the crossbar of the mounting kit sandwiched between them. See [Figure 37 on page 52](#).

Figure 36: Mounting Bar

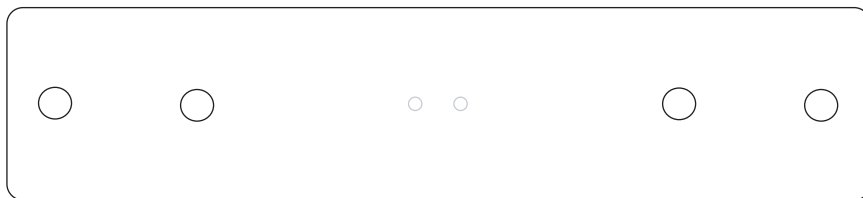
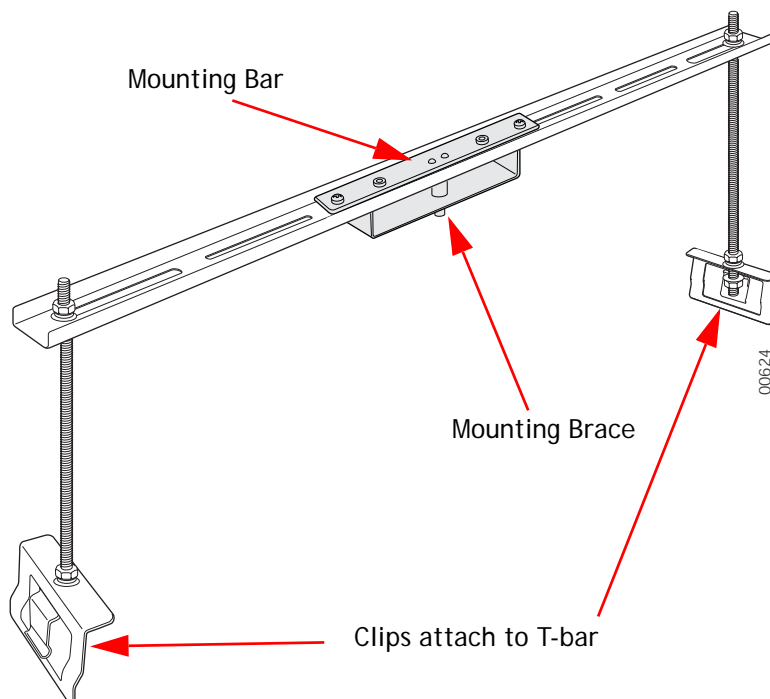

Figure 37: Assembled Mounting Bracket



4. Gently press the underside of the AP1000e against the mounting brace and rotate it into place until the locking mechanism clicks. Note that this is essentially the same process as depicted in [Figure 28 on page 47](#).
5. Attach the legs for the mounting kit to the T-Bars in the ceiling by sliding the clips down onto each respective bar.
6. Remove the top nut from each leg.
7. Lower the crossbar (with the AP attached) onto the legs and screw the nuts back on top of the bar.

8. Connect one end of the PoE Ethernet cable to the Ethernet connector on the AP.



Be sure to connect the Ethernet cable to the Ethernet port; the cable can mistakenly be plugged into the Console port. If you do this, the AP won't power up.



Use a shielded Cat 5e (or greater) Ethernet cable in order to comply with international electromagnetic emissions limits.

Check that the AP1000e is operating correctly before replacing the ceiling tile to the ceiling. Verify correct operation using the LEDs, as shown in [“Check AP1000e LEDs” on page 54](#).

Restoring AP1000e Settings

Trigger the Restore mechanism to return the AP1000e to the factory default settings. This overrides any changes that have been made from the controllers. Note that this restore mechanism differs from the ones on the other APs. Instead of a straight paper clip, you need to use a paper clip bent at a right angle to push the mechanism trigger located on the inside as indicated in the Figure below. Access it through the small hole with the bent paper clip. Press and hold the button for 10 seconds. After 10 seconds, the AP reboots and comes back up with default settings.

Figure 38: AP1000e Restore Button

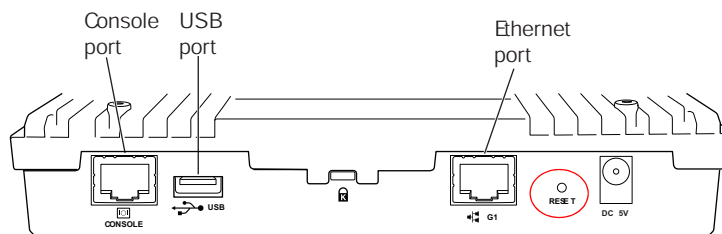

Check AP1000e LEDs

Figure 39: AP1000e Status LEDs

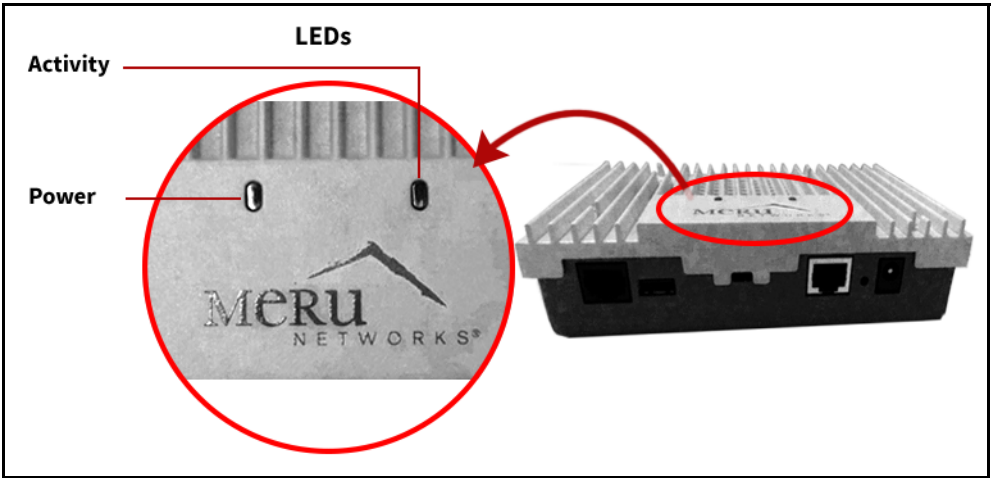

LED	Color	State
Status (right LED)	off	AP is off - either there is no power or the LEDs are set to Off on the controller. Check the LED setting on the controller by clicking Configuration > Devices > AP , selecting the AP and then checking the setting for LED Mode.
	cyan	AP is booting stage 1.
	green blinking	AP is booting stage 2.
	green/white alternating	AP is discovering the controller.
	green/blue alternating	AP is downloading a configuration from the controller.
	slow blue blinking	AP is online and enabled.
	rapid blue blinking	AP is online and enabled and there is activity on one or both radios.
	red/yellow alternating	Some AP failure occurred; check the controller for more details about the alarm by clicking Monitor > Alarms > Pending Alarms .
	blue/yellow alternating	AP is online and enabled and one or both radios are either scanning or an admin has taken the radio(s) down.

LED	Color	State
LAN (left LED)	green	LAN link is up.
	green blinking	LAN link is up and some activity is taking place.
	red	Link has either failed or has been brought down.
	alternating green/orange	Link is experiencing receive errors.

The AP1000e has two LEDs, Status and LAN, as shown in [“Check AP1000e LEDs” on page 54](#). If you want to change the appearance of the LEDs, follow these steps:

1. From the controller, click **Configuration > Devices > AP**, and then select the AP.
2. Select one of these settings for the LED Mode setting:
 - **Normal:** LEDs are as described above
 - **Blink:** Sets all LEDs flashing; this is useful to locate an AP
 - **Dark:** Turns off all LEDs
3. Click **OK**.

Where to Go From Here

Now that the AP1000e is installed, go to the **Fortinet System Director Getting Started Guide** for instructions on initializing the hardware. Return to this chapter to check the status of the LEDs once the WLAN is operational; note that LED status is configurable, so the chart above may not apply to APs whose status was reconfigured.

5

Installing AP1014i

AP1014i is supported by System Director versions 5.3 and greater. This chapter describes how to install and configure an AP1014i. It contains the following sections:

- [“Safety Precautions” on page 57](#)
- [“Unpack the AP1014i” on page 57](#)
- [“Power Requirements” on page 58](#)
- [“Additional Equipment” on page 58](#)
- [“Installing AP1014i” on page 59](#)
- [“Restoring AP1014i Settings” on page 75](#)
- [“Check AP1014i LEDs” on page 76](#)
- [“Where to Go From Here” on page 77](#)

Safety Precautions

IMPORTANT—Read and follow the regulatory instructions in Appendix B before installing and operating this product.

The AP1014i is only intended for installation in Environment A as defined in IEEE 802.3af. All directly interconnected equipment (e.g., equipment sharing an electrical source) must be contained within the same building, including the interconnected equipment's associated LAN connection.

Unpack the AP1014i

AP1014i is a single-radio AP that provides four additional wired Ethernet ports. Confirm that the shipping box contains the following:

- AP1014i

- Locking tool for ceiling mount locking



If you want to lock AP1014i to the wall, you need the optional kit MNT-WMKIT-01.

Power Requirements

Radios on an AP1014i use 2x2 MIMO configuration. To power an AP1014i, use either an 802.3af or 802.3at PoE cable; either one works automatically with no configuration required. For a list of supported PoEs, see the appendix [“Supported Power Over Ethernet Devices for Fortinet APs” on page 93](#)

Additional Equipment

The following AP1014i mounting options require the listed additional equipment:

Installation Type	Additional Equipment
Ceiling mounting on a suspended ceiling with or without locking	<ul style="list-style-type: none">• Either an 802.3af or 802.3at PoE cable
Wall mounting	<ul style="list-style-type: none">• Either an 802.3af or 802.3at PoE cable• Wall mount screws – Recommend #6, #8 (M3, M3.5)
Wall mounting with locking	<ul style="list-style-type: none">• Either an 802.3af or 802.3at PoE cable• Locking Kit 840-00052 MNT-WMKIT-01
Ceiling mounting with lowered tiles	<ul style="list-style-type: none">• Either an 802.3af or 802.3at PoE cable• Recessed Ceiling Mount Kit 840-0005x MNT-SCRM-KIT-03 or -04

Installing AP1014i

Select a Location

All AP1014i interconnected equipment must be contained within the same building, including the interconnected equipment's associated LAN connection. Ceiling mounting is recommended but wall mounting is also supported. In addition, the AP1014i should be mounted in a location that meets the following conditions:

- Relatively unobstructed access to the clients the AP serves. Select a location with minimal physical obstructions between the AP and the wireless clients. We recommend planning for about 20 data clients per radio (or per interference region) if you plan to use Virtual Port. This is the recommendation for a data-only installation. Refer to the Fortinet Deployment Guides on the support site for more information.
- In an office with cubicles, mount the APs below a hanging ceiling or on the wall near the ceiling to provide the least obstructed communications path.
- On a wall, orient the AP1014i horizontally so that you can read the Meru logo without tilting your head at 90 degrees - this orientation provides optimum MIMO performance.
- AP1014i is designed to provide 180 degree directional coverage as illustrated below. Plan placement with this pattern in mind.

Figure 40: Coverage Pattern for AP1014i When Ceiling Mounted



- If you install AP1014i on a pole, keep in mind that coverage will be 180 degrees; the pattern shown above would be directed sideways. We do not recommend mounting two AP1014is back to back on a pole to achieve 360 degree coverage, however, because the two units could interfere with each other.

Install the Access Point

You can mount AP1014i in any of the following ways:

- [“Mount AP1014i Below a Suspended Ceiling” on page 60](#)
- [“Mount AP1014i on a Dropped Ceiling Bevel Tile” on page 62](#)
- [“Mount AP1014i on an Interlude T-Bar” on page 65](#)
- [“Mount AP1014i on a Wall” on page 68](#)
- [“Mount AP1014i on a Wall Using the Optional Locking Kit” on page 70](#)

- “Set AP1014i on a Shelf” on **page 71**
- “Mount AP1014i Above a Suspended Ceiling” on **page 72**

Mount AP1014i Below a Suspended Ceiling

AP1014i ships ready to mount below a suspended ceiling; the built-in clips snap onto a ceiling rail. To mount an AP1014i below a suspended ceiling, follow these steps:

1. Remove the ceiling tiles at the location the AP will be mounted.
2. Be sure that AP1014i is not locked by inserting the locking key into the Unlock mechanism as shown in [Figure 41 on page 60](#) below.

Figure 41: Unlock AP1014i

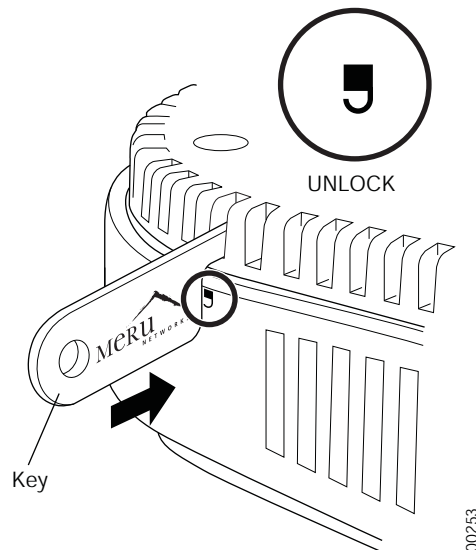

3. Align the ceiling t-bar with the AP1014i slots indicated in [Figure 42 on page 61](#) below.

Figure 42: Install AP1014i Below a Suspended Ceiling

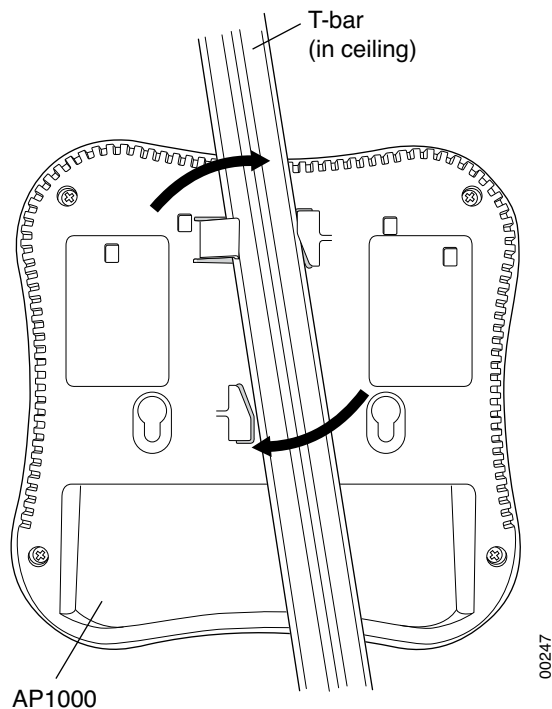

4. Press down on the tab indicated in [Figure 42 on page 61](#) above and rotate the AP1014i into place.
5. Connect one end of the CAT5 (or greater) Ethernet cable with PoE to the 100/1000 Ethernet connector shown in [Figure 43 on page 62](#) below.



Be sure to connect the Ethernet cable to the green uplink port. The yellow ports can be used to connect wired clients to the AP.

Figure 43: AP1014i Green Uplink Port

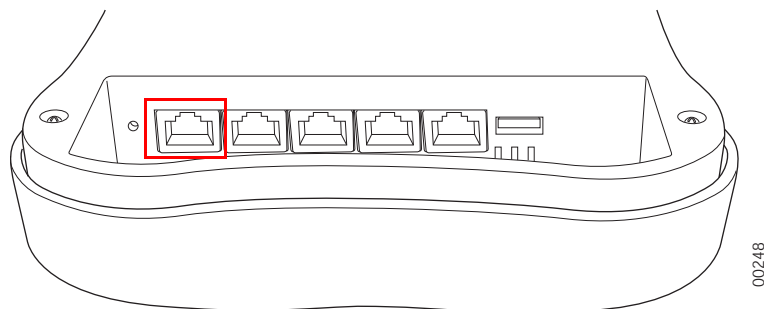

6. If you want to lock AP1014i in place, use the supplied locking tool to press the AP1014i locking mechanism shown in [Figure 44 on page 62](#).

Figure 44: Optionally lock AP1014i

AP1000 (mounted on ceiling)

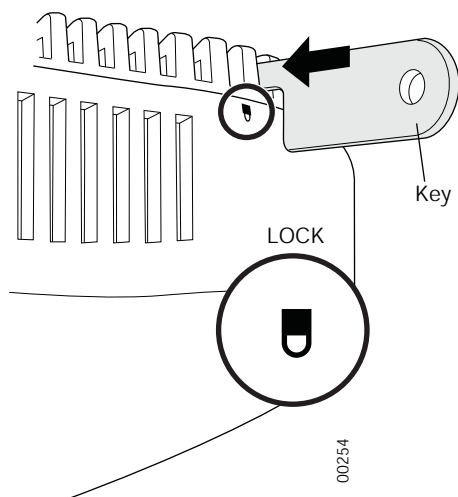

7. To unlock AP1014i, press the unlocking mechanism on the opposite side of AP1014i see [Figure 41 on page 60](#).

Mount AP1014i on a Dropped Ceiling Bevel Tile

The mounting procedure for a ceiling that has recessed supports and lowered tiles is similar to that of mounting on a suspended ceiling. However, this procedure requires a specialized mounting bracket (ACC-MNT-SCRMKIT-03), as shown in [Figure 45 on page 63](#).

Figure 45: Dropped Bevel Tile Mounting Bracket

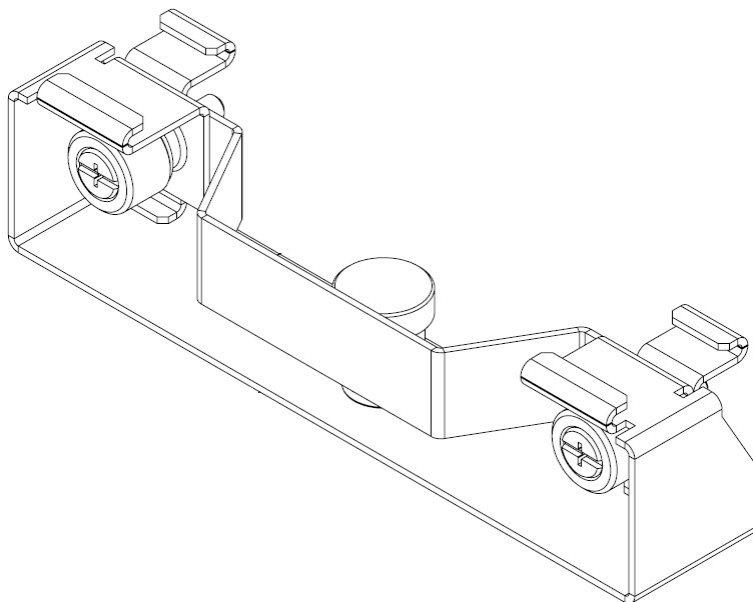

1. Remove the ceiling tile alongside which the AP will be mounted.
2. Be sure that AP1014i is not locked by inserting the locking key into the Unlock mechanism as shown in [Figure 46 on page 63](#) below.

Figure 46: Unlock AP1014i

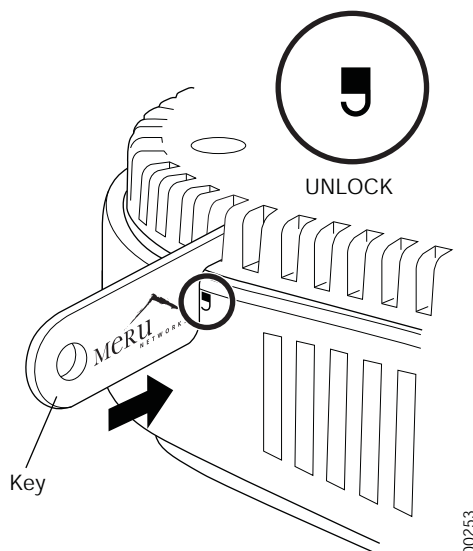

00253

3. Align the mounting bracket with the AP1014i slots used for the ceiling t-bar in the previous section (as shown in [Figure 42 on page 61](#)).
4. Press down on the tab indicated in [Figure 42 on page 61](#) and rotate the AP1014i into place.
5. Push down on the thumbscrews provided on the mounting bracket and clip it to the ceiling bar that will support the AP.
6. Tighten the screws to ensure that the mechanism stays locked in place.
7. Connect one end of the CAT5 (or greater) Ethernet cable with PoE to the 100/1000 Ethernet connector shown in [Figure 47 on page 64](#) below.



Be sure to connect the Ethernet cable to the green uplink port. The yellow ports can be used to connect wired clients to the AP.

Figure 47: AP1014i Green Uplink Port

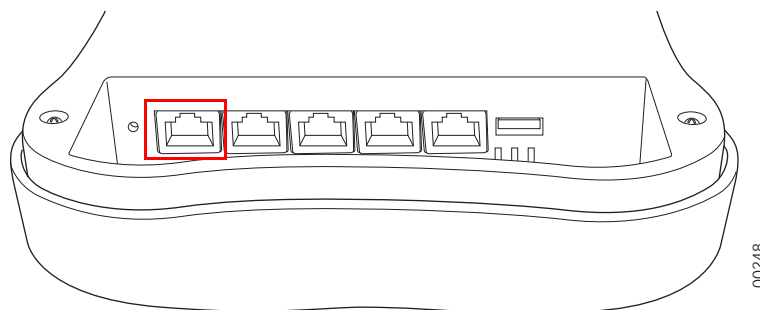

8. If you want to lock AP1014i in place, use the supplied locking tool to press the AP1014i locking mechanism shown in [Figure 48 on page 65](#).

Figure 48: Optionally lock AP1014i

AP1000 (mounted on ceiling)

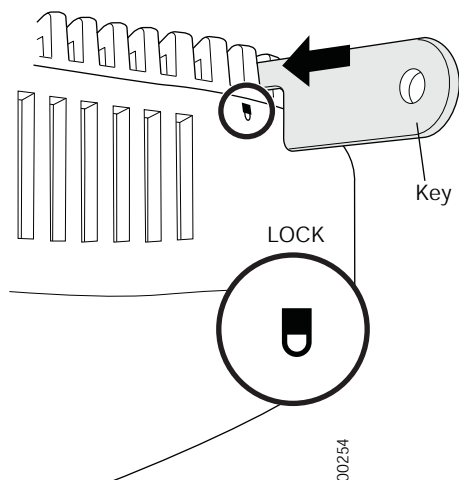

9. To unlock AP1014i, press the unlocking mechanism on the opposite side of AP1014i see [Figure 46 on page 63](#).

Mount AP1014i on an Interlude T-Bar

The mounting procedure for a ceiling that has interlude T-Bar supports is similar to that of mounting on a suspended ceiling. However, this procedure requires a specialized mounting bracket (ACC-MNT-SCRMKIT-04), as depicted in [Figure 49 on page 66](#).

Figure 49: T-Bar Mounting Bracket

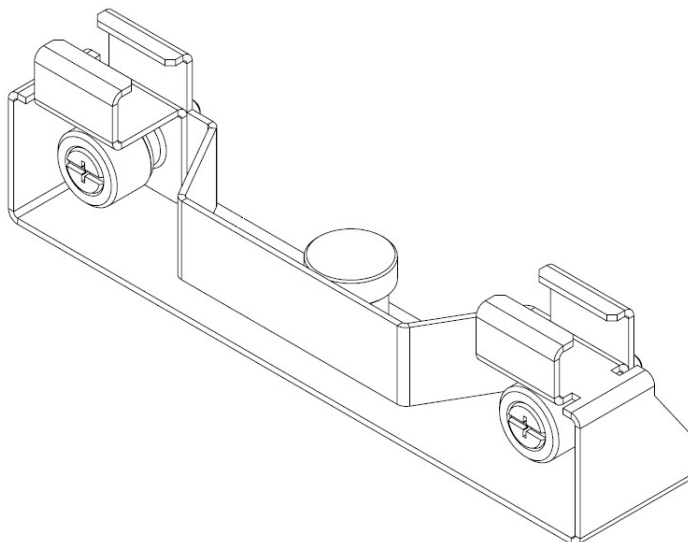

1. Remove the ceiling tile alongside which the AP will be mounted.
2. Be sure that AP1014i is not locked by inserting the locking key into the Unlock mechanism as shown in [Figure 46 on page 63](#) below.

Figure 50: Unlock AP1014i

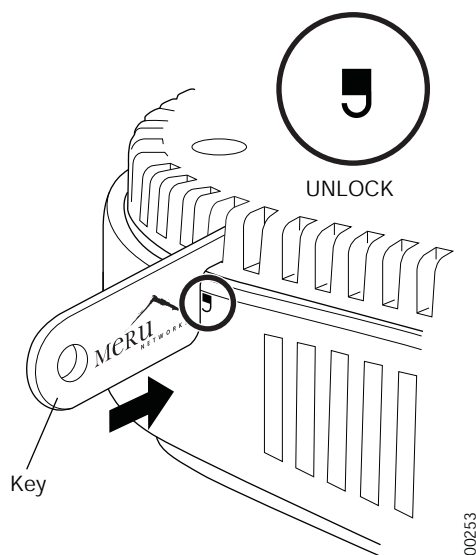

3. Align the mounting bracket with the AP1014i slots used for the ceiling t-bar in the previous section (as shown in [Figure 42 on page 61](#)).

4. Press down on the tab indicated in [Figure 42 on page 61](#) and rotate the AP1014i into place.
5. Push down on the thumbscrews provided on the mounting bracket and clip it to the ceiling bar that will support the AP.
6. Tighten the screws to ensure that the mechanism stays locked in place.
7. Connect one end of the CAT5 (or greater) Ethernet cable with PoE to the 100/1000 Ethernet connector shown in [Figure 51 on page 67](#) below.



Be sure to connect the Ethernet cable to the green uplink port. The yellow ports can be used to connect wired clients to the AP.

Figure 51: AP1014i Green Uplink Port

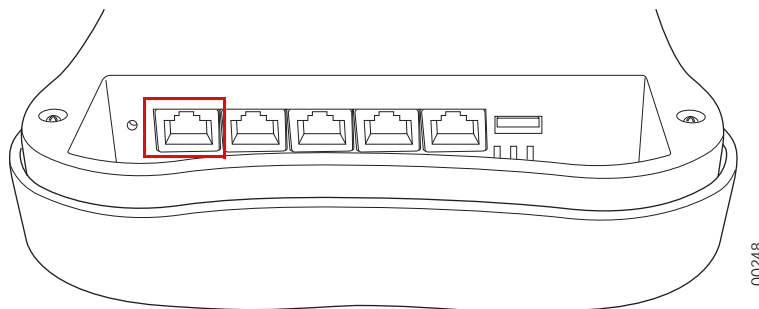

8. If you want to lock AP1014i in place, use the supplied locking tool to press the AP1014i locking mechanism shown in [Figure 48 on page 65](#).

Figure 52: Optionally lock AP1014i

AP1000 (mounted on ceiling)

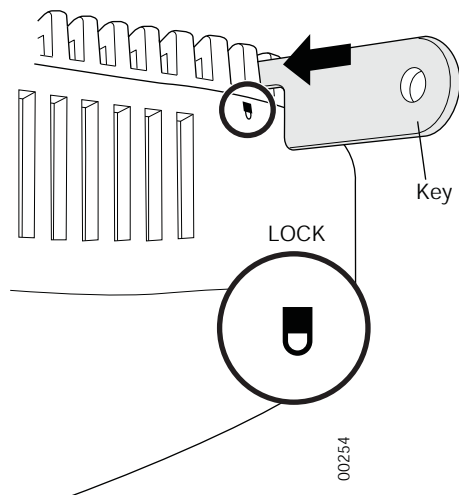

9. To unlock AP1014i, press the unlocking mechanism on the opposite side of AP1014i see [Figure 46 on page 63](#).

Mount AP1014i on a Wall

The AP1014i attaches directly to the wall. To mount an AP1014i on sheet rock or wall studs, follow these steps:

1. Attach two appropriate screws (see [“Additional Equipment” on page 58](#) for screw information) to the wall 3 inches apart (76mm) as shown below ([Figure 53 on page 69](#)).

Figure 53: AP1014i Wall Bracket

Wall mount with screws.

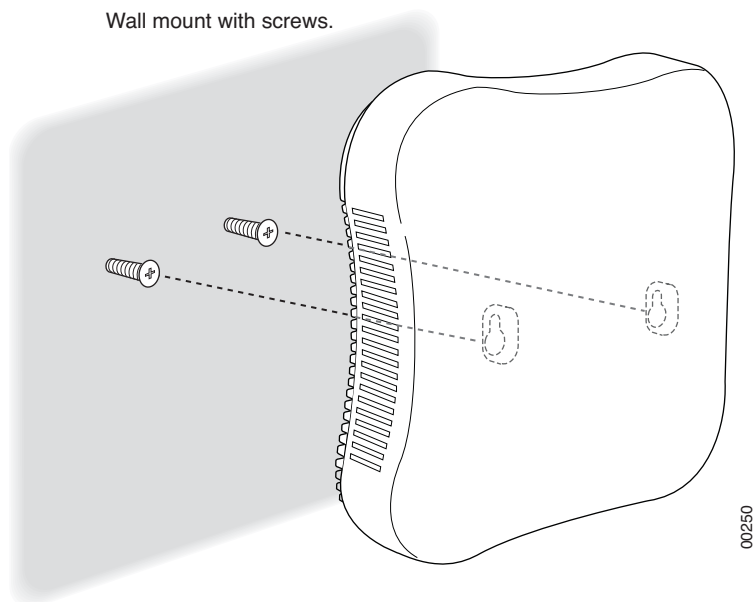

2. Attach the PoE Ethernet cable to the Ethernet port shown in [Figure 54 on page 69](#).



Be sure to connect the Ethernet cable to the green uplink port. The yellow ports can be used to connect wired clients to the AP.

Figure 54: AP1014i Green Uplink Port

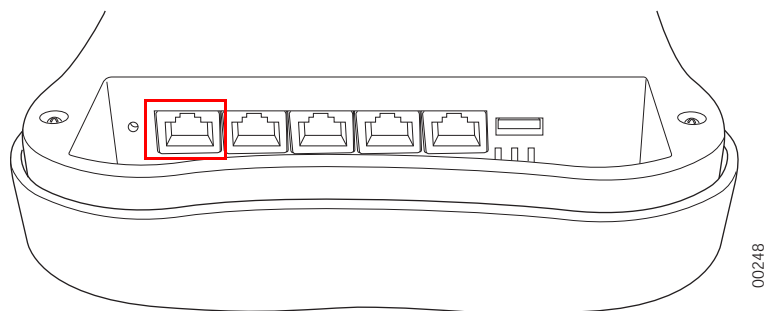

3. Align the screws on the wall with the keyholes on the AP and slide the unit down slightly. See [Figure 53 on page 69](#).

Mount AP1014i on a Wall Using the Optional Locking Kit

The AP1014i locking wall mount kit (840-00052 MNT-WMKIT-01) contains a wall bracket, screws, and a locking key. To mount an AP1014i on sheetrock or wall studs with this kit, follow these steps:

1. Attach AP1014i to the bracket as shown in [Figure 55 on page 70](#).

Figure 55: Attach AP1014i to Wall Bracket

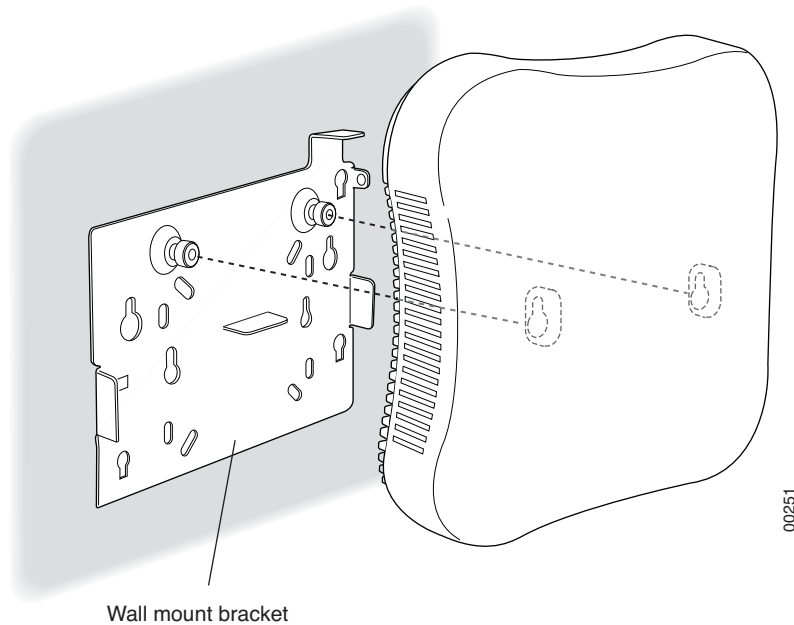

2. Insert the locking key and apply a small suitcase lock as shown in [Figure 56 on page 71](#).

Figure 56: AP1014i Locked to a Wall

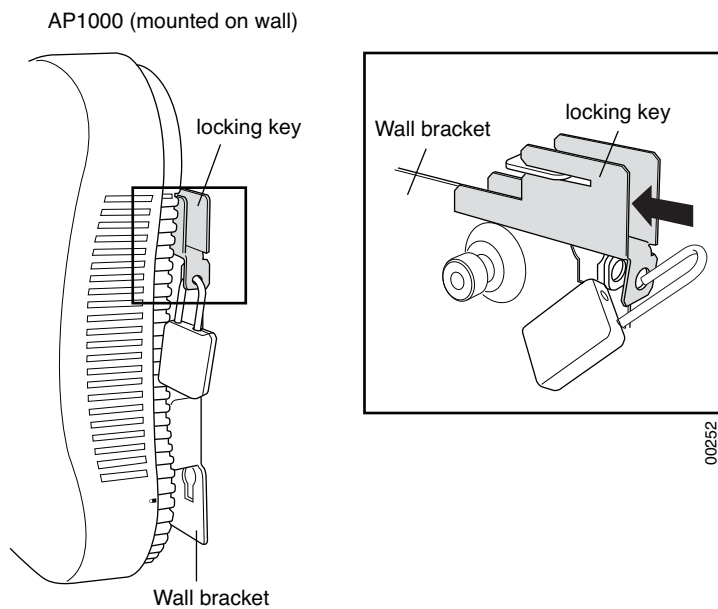

Set AP1014i on a Shelf

Set AP1014i on any horizontal surface and then connect a PoE Ethernet cable.



Be sure to connect the Ethernet cable to the green uplink port. The yellow ports can be used to connect wired clients to the AP.

Figure 57: AP1014i Green Uplink Port

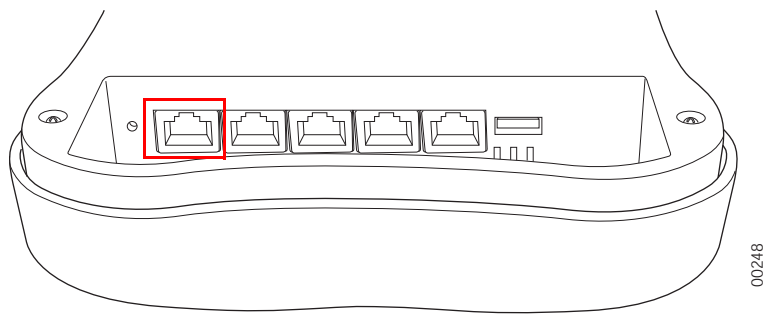

Mount AP1014i Above a Suspended Ceiling



AP1014i is not plenum-rated and should only be mounted above ceilings in non-plenum air space, such as a return airflow for air conditioning.

Use the optional T-bar box hanger mounting kit to mount AP1014i above suspended ceiling T-rails. The installation attaches the T-bar box hanger to the ceiling rails and then the AP1014i attaches to the T-bar box hanger. Note that AP1014i mounted above the ceiling has about 2-3 dBm less RF coverage than AP1014i mounted under the ceiling.

You may need to modify thicker tiles to support this installation.



When installed in air-handling spaces, such as above a suspended ceiling, power the AP1014i only with a PoE, not a power supply.

To mount an AP1014i above the ceiling with the optional T-bar kit, follow these steps:

1. Determine the location on the ceiling rails where the AP will be mounted and remove the ceiling tile.
2. Unpack the T-bar hanger kit.
3. Unlock the AP using the provided key.

Figure 58: Unlock AP1014i

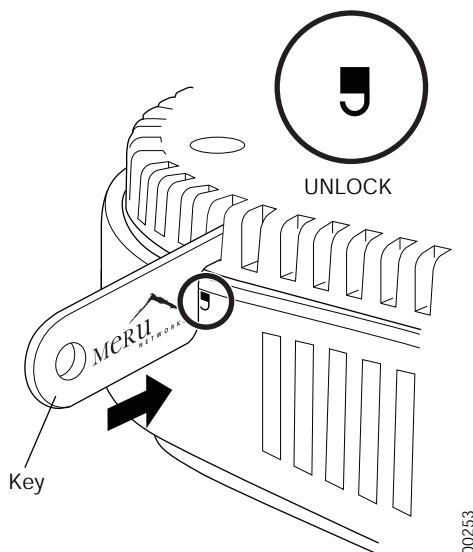

4. Attach the mounting bar (depicted in [Figure 59 on page 73](#)) to the mounting brace (which looks like a small handle) with the crossbar of the mounting kit sandwiched between them. See [Figure 60 on page 73](#).

Figure 59: Mounting Bar



Figure 60: Assembled Mounting Bracket

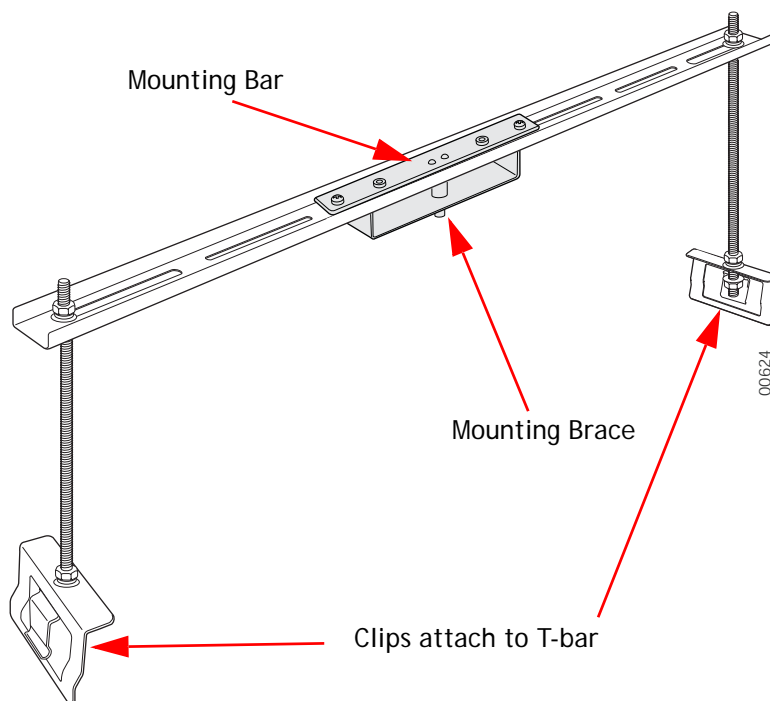

5. Gently press the underside of the AP1014i against the mounting brace and rotate it into place until the locking mechanism clicks. Note that this is essentially the same process as depicted in [Figure 42 on page 61](#).
6. Lock the AP1014i in place using the provided key.

Figure 61: Lock AP1014i

AP1000 (mounted on ceiling)

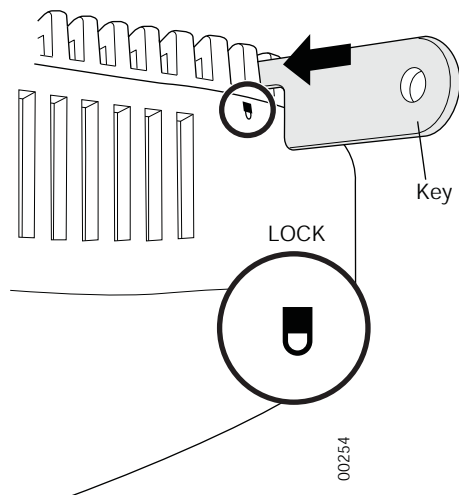

7. Attach the legs for the mounting kit to the T-Bars in the ceiling by sliding the clips down onto each respective bar.
8. Remove the top nut from each leg.
9. Lower the crossbar (with the AP attached) onto the legs and screw the nuts back on top of the bar.
10. Connect one end of the PoE Ethernet cable to the Ethernet connector on the AP.



Be sure to connect the Ethernet cable to the green uplink port. The yellow ports can be used to connect wired clients to the AP.

Figure 62: AP1014i Green Uplink Port

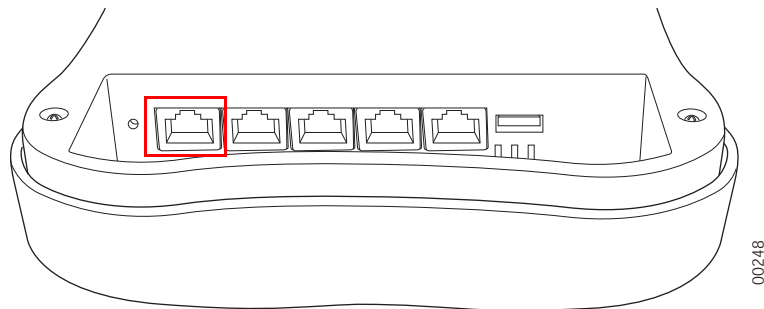

00248



Use a shielded Cat 5e (or greater) Ethernet cable in order to comply with international electromagnetic emissions limits.

Check that the AP1014i is operating correctly before replacing the ceiling tile to the ceiling. Verify correct operation using the LEDs, as shown in [“Check AP1014i LEDs” on page 76](#).

Restoring AP1014i Settings

Trigger the Restore mechanism to return the AP1014i to the factory default settings. This overrides any changes that have been made from the controllers. Note that this restore mechanism differs from the ones on the other APs. Instead of a straight paper clip, you need to use a paper clip bent at a right angle to push the mechanism trigger located on the inside as indicated in the Figure below. Access it through the small hole with the bent paper clip. Press and hold the button for 10 seconds. After 10 seconds, the AP reboots and comes back up with default settings.

Figure 63: AP1014i Restore Button

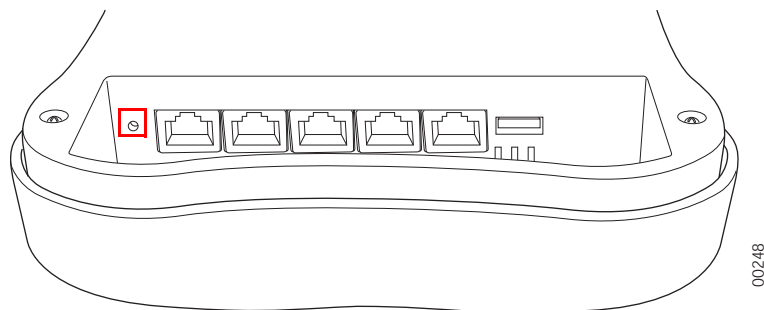

00248

Check AP1014i LEDs

Figure 64: *AP1014i Status LEDs*

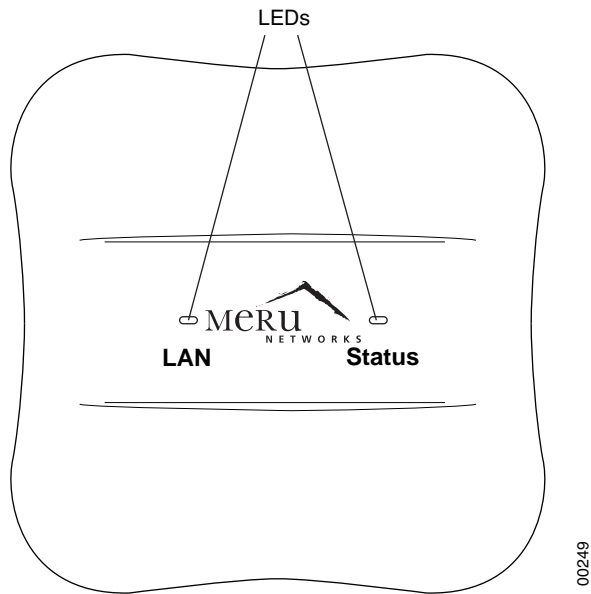

LED	Color	State
Status (right LED)	off	AP is off - either there is no power or the LEDs are set to Off on the controller. Check the LED setting on the controller by clicking Configuration > Devices > AP , selecting the AP and then checking the setting for LED Mode.
	cyan	AP is booting stage 1.
	green blinking	AP is booting stage 2.
	green/white alternating	AP is discovering the controller.
	green/blue alternating	AP is downloading a configuration from the controller.
	slow blue blinking	AP is online and enabled.
	rapid blue blinking	AP is online and enabled and there is activity on one or both radios.
	red/yellow alternating	Some AP failure occurred; check the controller for more details about the alarm by clicking Monitor > Alarms > Pending Alarms .
	blue/yellow alternating	AP is online and enabled and one or both radios are either scanning or an admin has taken the radio(s) down.
LAN (left LED)	Off	This LED is not used, and will always be off.

If you want to change the appearance of the LED, follow these steps:

1. From the controller, click **Configuration > Devices > AP**, and then select the AP.
2. Select one of these settings for the LED Mode setting:
 - **Normal:** LED is as described above
 - **Blink:** Sets the LED flashing; this is useful to locate an AP
 - **Dark:** Turns off the LED
3. Click **OK**.

Where to Go From Here

Now that the AP1014i is installed, go to the **Fortinet System Director Getting Started Guide** for instructions on initializing the hardware. Return to this chapter to check the status of the LEDs once the WLAN is operational; note that LED status is configurable, so the chart above may not apply to APs whose status was reconfigured.



Cautions and Warnings

The cautions and warnings that appear in this manual are listed below in English, German, French, and Spanish.

Cautions

A Caution calls your attention to a possible hazard that can damage equipment.

"Vorsicht" weist auf die Gefahr einer möglichen Beschädigung des Gerätes in.

Une mise en garde attire votre attention sur un risque possible d'endommagement de l'équipement. Ci-dessous, vous trouverez les mises en garde utilisées dans ce manuel.

Un mensaje de precaución le advierte sobre un posible peligro que pueda dañar el equipo. Las siguientes son precauciones utilizadas en este manual.



When changing the orientation of the antennas, be sure to slightly loosen the knurled ring before moving the antenna. Retighten the ring afterward. Otherwise, you might damage the internal cabling in the AP.

Bei einer Neuausrichtung der Antennen muss vor Bewegung der Antenne der Rändelring leicht gelockert werden. Anschließend den Ring wieder festziehen. Anderenfalls können die internen Kabel im AP beschädigt werden.

En cas de modification d'orientation des antennes, veiller à desserrer légèrement la bague moletée avant de réorienter l'antenne. Resserrer ensuite la bague, faute de quoi le câblage interne du point d'accès pourrait être endommagé.

Al cambiar la orientación de las antenas, asegúrese de aflojar ligeramente el anillo estriado antes de mover la antena. Luego vuelva a apretar el anillo. De otro modo, podría dañar el cableado interno del punto de acceso.



Be sure to connect the Ethernet cable to the Ethernet port; the cable can mistakenly be plugged into the Console port.

Darauf achten, dass das Ethernetkabel am Ethernetanschluss und nicht versehentlich am Konsolenanschluss angeschlossen wird.

Veiller à bien connecter le câble Ethernet au port Ethernet et non pas au port Console.

Asegúrese de conectar el cable Ethernet al puerto Ethernet, porque por error se puede enchufar en el puerto de la consola.



The radiated output power of the access points is well below the FCC radio frequency exposure limits. However, the Fortinet Access Point should be used in such a manner that the potential for human contact during normal operation is minimized. To avoid the possibility of exceeding the FCC radio frequency exposure limits, you should keep a distance of at least 20 cm between you (or any other person in the vicinity) and the Access Point antennas.

Die abgestrahlte Ausgangsleistung von Geräten von Fortinet, Inc. liegt weit unter den Hochfrequenz-Expositionsgrenzwerten der FCC. Die Fortinet Access Point Zugangspunkte von Fortinet, Inc. sollten jedoch so verwendet werden, dass das Potenzial für Kontakt mit Menschen während des normalen Betriebs auf ein Mindestmaß beschränkt wird. Um die Möglichkeit einer Überschreitung der FCC-Hochfrequenz-Expositionsgrenzwerte zu vermeiden, ist ein Abstand von mindestens 20 cm zwischen Ihnen (bzw. einer anderen Person in der Nähe) und den Zugangspunkt-Antennen zu wahren.

La puissance de rayonnement émise par les équipements Fortinet, Inc. est très inférieure aux limites d'exposition aux fréquences radio définies par la FCC. Toutefois, les points d'accès de la série Fortinet Access Point de Fortinet, Inc. doivent être utilisés de façon à éliminer tout risque de contact humain en fonctionnement normal. Pour éviter de dépasser les limites d'exposition aux fréquences radio définies par la FCC, il est impératif de préserver en permanence une distance supérieure ou égale à 20 cm entre l'utilisateur (ou toute personne se trouvant à proximité) et les antennes du point d'accès.

La potencia de radiación de los dispositivos de Fortinet, Inc. está muy por debajo de los límites de exposición a radiofrecuencia estipulados por la FCC. No obstante, los puntos de acceso de la serie Fortinet Access Point de Fortinet, Inc. deben usarse de tal manera que se minimice la posibilidad de contacto para el usuario durante la operación normal. Para evitar la posibilidad de exceder los límites de exposición a radiofrecuencia establecidos por la FCC, el usuario (o cualquier otra persona en torno) debe mantenerse a una distancia de al menos 20 cm respecto a las antenas del punto de acceso.



Exposure to Radio Frequency Radiation.

The installer of this radio equipment must ensure that the antenna is located or pointed such that it does not emit an RF field in excess of Health Canada limits for the general population; consult Safety Code 6, obtainable from Health Canada's website <http://www.hc-sc.gc.ca/rpb>.

Exposure to Radio Frequency Radiation.

The installer of this radio equipment must ensure that the antenna is located or pointed such that it does not emit an RF field in excess of Health Canada limits for the general population; consult Safety Code 6, obtainable from Health Canada's website <http://www.hc-sc.gc.ca/rpb>.

Exposition aux rayonnements à fréquence radioélectrique

L'installateur de cet équipement radio doit veiller à positionner et orienter l'antenne de telle sorte qu'elle n'émette pas un champ radioélectrique supérieur aux limites définies par Santé Canada pour la population générale. Consulter le Code de sécurité n° 6, disponible sur le site Web de Santé Canada à l'adresse <http://www.hc-sc.gc.ca/rpb>.

Exposición a la radiación de radiofrecuencia.

El instalador de este equipo de radio debe cerciorarse de que la antena está localizada u orientada de tal manera que no emita un campo de radiofrecuencia superior a los límites estipulados por Health Canada para la población; consulte el Código de Seguridad 6 que podrá encontrar en el página web de Health Canada, <http://www.hc-sc.gc.ca/rpb>.

Warnings

A warning calls your attention to a possible hazard that can cause injury or death. The following are the warnings used in this manual.

"Achtung" weist auf eine mögliche Gefährdung hin, die zu Verletzungen oder Tod führen können. Sie finden die folgenden Warnhinweise in diesem Handbuch:

Un avertissement attire votre attention sur un risque possible de blessure ou de décès. Ci-dessous, vous trouverez les avertissements utilisés dans ce manuel.

Una advertencia le llama la atención sobre cualquier posible peligro que pueda ocasionar daños personales o la muerte. A continuación se dan las advertencias utilizadas en este manual.

	<p>With plastic covers removed, this product is suitable for use in environmental air space in accordance with the Section 300-22(c) of the National Electric Code and Sections 2- 128.12 - 010 (3) and 12 - 100 of the Canadian Electrical Code. Part 1. C22. 1. For other countries, consult local authorities for regulations.</p> <p>Bei abgenommener Kunststoffabdeckung ist dieses Produkt zur Verwendung in einem Umgebungsluftraum gemäß Abschnitt 300-22(c) des National Electric Code und Abschnitt 2- 128.12 - 010 (3) und 12 - 100 des Canadian Electrical Code Teil 1. C22.1 geeignet. Die Vorschriften für andere Länder sind bei den örtlichen Behörden erhältlich.</p> <p>Sous réserve que ses couvercles de plastique soient déposés, cet appareil est adapté à une utilisation dans les vides de construction des bâtiments selon la section 300-22(c) du code NEC (National Electric Code) et les sections 2- 128.12 - 010 (3) et 12 - 100 du Code électrique du Canada, partie 1. C22. 1. Pour tous les autres pays, consulter les organismes de réglementation locaux.</p> <p>Una vez desprendidas las cubiertas de plástico, este producto es adecuado para su uso en el espacio aéreo circundante en conformidad con la sección 300-22(c) del National Electric Code (Código Eléctrico Nacional de EE.UU.) y las secciones 2- 128.12 - 010 (3) y 12 - 100 del Código Eléctrico de Canadá. Parte 1. C22. 1. En otros países, consulte a las autoridades locales competentes para informarse acerca de las normativas vigentes.</p>
	<p>Any Fast Ethernet (FE) cables installed in air-handling spaces should be suitable under NEC Article 800.50 and marked accordingly for use in plenums and air-handling spaces with regard to smoke propagation, such as CL2-P, CL3-P, MPP (Multi Purpose Plenum), or CMP (Communications Plenum).</p> <p>Alle Fast-Ethernet (FE)-Kabel, die in Lüftungsräumen installiert werden, sollten gemäß NEC Artikel 800.50 geeignet sein und entsprechend zur Verwendung in Hohlräumen (Plenum) und Lüftungsräumen im Hinblick auf Rauchausbreitung gekennzeichnet sein, z.B. CL2-P, CL3-P, MPP (Multi Purpose Plenum) oder CMP (Communications Plenum).</p> <p>Les câbles Fast Ethernet (FE) installés dans un vide d'air doivent correspondre aux critères de l'article 800.50 du code NEC et identifiés en conséquence comme adaptés à une utilisation dans les vides de construction des bâtiments en matière de propagation de la fumée (marquages CL2-P, CL3-P, MPP (Multi Purpose Plenum) ou CMP (Communications Plenum)).</p> <p>Todos los cables Fast Ethernet (FE) instalados en espacios aéreos deben cumplir con el artículo 800.50 del NEC y estar marcados adecuadamente para su uso en espacios aéreos y plenums en lo concerniente a la propagación de humo, tales como CL2-P, CL3-P, MPP (Plenum multifuncional), o CMP (Plenum de comunicaciones).</p>



Inside antennas must be positioned to observe minimum separation of 20 cm. (~ 8 in.) from all users and bystanders. For the protection of personnel working in the vicinity of inside (downlink) antennas, the following guidelines for minimum distances between the human body and the antenna must be observed.

The installation of the indoor antenna must be such that, under normal conditions, all personnel cannot come within 20 cm. (~ 8.0 in.) from any inside antenna. Exceeding this minimum separation will ensure that the employee or bystander does not receive RF-exposure beyond the Maximum Permissible Exposure according to FCC CFR 47, section 1.1310 i.e. limits for General Population/Uncontrolled Exposure.

Innenantennen müssen so positioniert werden, dass ein Mindestabstand von 20 cm (ca. 8 Zoll) zu allen Benutzern und anderen Personen gewahrt wird. Zum Schutz von Personal, das in der Nähe von Innenantennen (Downlink) arbeitet, sind die folgenden Richtlinien für Mindestabstand zwischen dem menschlichen Körper und der Antenne zu beachten.

Die Innenantenne muss so installiert werden, dass sich unter normalen Bedingungen kein Personal bis auf weniger als 20 cm (ca. 8 Zoll) an eine Innenantenne annähern kann. Durch Überschreitung dieses Mindestabstands wird sichergestellt, dass Mitarbeiter oder andere Personen keiner RF-Exposition über die maximal zulässige Exposition (MPE; Maximum Permissible Exposure) gemäß FCC CFR 47, Abschnitt 1.1310 (Grenzwerte für die allgemeine Bevölkerung/unkontrollierte Exposition) ausgesetzt werden.

Les antennes intérieures doivent être positionnées de façon à respecter une distance minimum de 20 cm par rapport aux utilisateurs et aux tiers. Pour la protection du personnel travaillant à proximité des antennes intérieures (liaison descendante), respecter les directives suivantes pour assurer des distances minimales entre les êtres humains et les antennes.

Toute antenne intérieure doit être installée de telle sorte que, dans des conditions normales, le personnel ne puisse s'en approcher à moins de 20 cm. Cette distance minimale est destinée à garantir qu'un employé ou un tiers ne sera pas exposé à un rayonnement radioélectrique supérieur à la valeur maximale autorisée, telle qu'elle est définie dans les limites d'exposition non contrôlées pour la population par la réglementation de la FCC CFR 47, section 1.1310.

Las antenas interiores deben colocarse de manera que se observe una separación mínima de 20 cm. (~ 8 pulg.) respecto a todos los usuarios y circunstantes. Para la protección del personal que trabaje en las inmediaciones de las antenas interiores (receptoras), deben observarse las siguientes directrices relativas a la distancia mínima entre el cuerpo humano y la antena.

La instalación de la antena interior debe efectuarse de tal modo que, en condiciones normales, ningún miembro del personal pueda acercarse a menos de 20 cm. (~ 8,0 pulg.) de cualquier antena interior. El cumplimiento de este mínimo de separación asegura que el empleado o circunstante no recibirá exposición a radiofrecuencia por encima de la Exposición Máxima Permisible conforme a la normativa FCC CFR 47, sección 1.1310, es decir, los límites asignados a la Exposición Incontrolada/Población Civil.



Regulatory Information

The Meru Access Point (APs) must be installed and used in strict accordance with the manufacturer's instructions as described in the user documentation that comes with the product. For country-specific approvals, see below. Meru Networks, Inc. is not responsible for any radio or television interference caused by unauthorized modification of APs, or the substitution or attachment of connecting cables and equipment other than that specified by Meru Networks, Inc. The correction of interference caused by such unauthorized modification, substitution or attachment is the responsibility of the user. Meru Networks, Inc. and its authorized resellers or distributors are not liable for any damage or violation of government regulations that may arise from the user failing to comply with these guidelines.

USA

Underwriters Laboratories

Use only with Listed I.T.E. equipment.

Notices

The unit is intended for installation in Environment A as defined in IEEE 802.3.af. All interconnected equipment must be contained within the same building, including the interconnected equipment's associated LAN connection.

Suitable for use in environmental air space in accordance with Section 300-22(c) of the National Electrical Code, and Sections 2-128, 12-010(3) and 12-100 of the Canadian Electrical Code, Part 1, C22.1.

FCC Radiation Exposure Statement



The radiated output power of the Fortinet devices is well below the FCC radio frequency exposure limits. However, the Access Point should be used in such a manner that the potential for human contact during normal operation is minimized. When installing and operating these devices, keep a minimum distance of 20 cm (8 inches) between the antennas and any persons/users in the vicinity.

Radio Frequency Interference Requirements



Fortinet Access Points

All devices except the OAP180 are indoor devices. The FCC requires indoor use for the frequency range 5.15 GHz to 5.25 GHz to reduce the potential for harmful interference to co-channel Mobile Satellite systems.

High-power radars are allocated as primary users of the 5.25 to 5.35 GHz and 5.65 to 5.85 GHz bands. These radar stations can cause interference with or damage to these devices, or both.

Interference Statement

This device complies with Part 15 of the FCC Rules. Operation is subject to the following two conditions: (1) This device may not cause harmful interference, and (2) this device must accept any interference received, including interference that may cause undesired operation.

This equipment has been tested and found to comply with the limits for a Class B digital device, pursuant to Part 15 of the FCC Rules. These limits are designed to provide reasonable protection against harmful interference in a residential installation. This equipment generates, uses, and can radiate radio frequency energy. If the equipment is not installed and used in accordance with the instructions, the equipment may cause harmful interference to radio communications. There is no guarantee, however, that such interference will not occur in a particular installation. If this equipment does cause harmful interference to radio or television reception (which can be determined by turning the equipment off and on), the user is encouraged to try to correct the interference by taking one or more of the following measures:

- Increase the separation between the equipment and receiver.
- Connect the equipment into an outlet on a circuit different from to which the receiver is connected.
- Consult the dealer or an experienced radio/TV technician for help.



The Fortinet Access Point must be installed and used in strict accordance with the manufacturer's instructions as described in the user documentation that comes with the product. Any other installation or use may violate FCC Part 15 regulations. Modifications not expressly approved by Fortinet, Inc. could void your authority to operate the equipment.

This device must not be co-located or operating in conjunction with any other antenna or transmitter.

For products available in the USA and Canadian markets, only channels 1 through 11 can be operated. Selection of other channels is not authorized.

Canada. Industry Canada (IC)

The Class B digital portion of this apparatus complies with Canadian standard ICES-003.

These devices comply with RSS210 of Industry Canada.

Per RSS 210 A9.5 point 7:

- (i) the device for the band 5150-5250 MHz is only for indoor usage to reduce potential for harmful interference to co-channel mobile satellite systems;
- (ii) the maximum antenna gain permitted (for devices in the bands 5250-5350 MHz and 5470-5725 MHz) to comply with the e.i.r.p. limit; and
- (iii) the maximum antenna gain permitted (for devices in the band 5725-5825 MHz) to comply with the e.i.r.p. limits specified for point-to-point and non point-to-point operation as appropriate, as stated in section A9.2(3).

In addition, users should also be cautioned to take note that high-power radars are allocated as primary users (meaning they have priority) of the bands 5250-5350 MHz and 5650-5850 MHz and these radars could cause interference and/or damage to LE-LAN devices.

- (iv) These devices are not permitted to operate in the 5600 - 5650 MHz band.

For products available in the USA and Canadian markets, only channels 1 through 11 can be operated. Selection of other channels is not authorized.

Operation is subject to the following two conditions: (1) this device may not cause interference, and (2) this device must accept any interference, including interference that may cause undesired operation of this device.

This device and its listed antenna(s) must not be co-located or operated in conjunction with any other antenna or transmitter

L'utilisation de ce dispositif est autorisée seulement aux conditions suivantes: (1) il ne doit pas produire de brouillage et (2) l'utilisateur du dispositif doit être prêt à accepter tout brouillage radioélectrique reçu, même si ce brouillage est susceptible de compromettre le fonctionnement du dispositif.

The term "IC" before the equipment certification number only signifies that the Industry Canada technical specifications were met.

To reduce the potential radio interference to other users, the antenna type and gain should be chosen so that the equivalent isotropically radiated power (EIRP) is not more than that required for successful communication.

To prevent radio interference to the licensed service, this device is intended to be operated indoors and away from windows to provide maximum shielding. Equipment (or its transmit antenna) that is installed outdoors is subject to licensing.

Pour empêcher que cet appareil cause du brouillage au service faisant l'objet d'une licence, il doit être utilisé à l'intérieur et devrait être placé loin des fenêtres afin de fournir un écran de blindage maximal. Si le matériel (ou son antenne d'émission) est installé à l'extérieur, il doit faire l'objet d'une licence.



Exposure to Radio Frequency Radiation.

The installer of this radio equipment must ensure that the antenna is located or pointed such that it does not emit an RF field in excess of Health Canada limits for the general population; consult Safety Code 6, obtainable from Health Canada's website <http://www.hc-sc.gc.ca/rpb>.

This equipment complies with IC RSS-102 radiation exposure limits set forth for an uncontrolled environment. This equipment should be installed and operated with a minimum distance of 20cm between the antennas and any persons/users in the vicinity.



These devices are restricted to indoor use because they operate in the 5.15 to 5.25 GHz frequency range. Industry Canada requires such products to be used indoors for the frequency range 5.15 GHz to 5.25 GHz to reduce the potential for harmful interference to co-channel Mobile Satellite systems.

Europe—EU Declaration of Conformity and Restrictions



This equipment is marked with either the CE Mark, the alert symbol, and the notified body's number and can be used throughout the European Community. This mark indicates compliance with the R&TTE Directive 1999/5/EC and the relevant parts of the following technical specifications.

EN 300 328. Electromagnetic Compatibility and Radio Spectrum Matters (ERM). Wideband transmission systems, data transmission equipment operating in the 2.4 GHz ISM (Industrial, Scientific, and Medical frequency bands in the range of 902–928 MHz, 2.4–2.485 GHz, and 5.15–5.25 GHz) band and using spread spectrum modulation techniques, harmonized EN standards covering essential requirements under article 3.2 of the R&TTE directive.

EN 301 893. Broadband Radio Access Networks (BRAN). 5 GHz high-performance RLAN, harmonized EN standards covering essential requirements of article 3.2 of the R&TTE directive.

EN 301 489-17. Electromagnetic Compatibility and Radio Spectrum Matters (ERM). Electromagnetic Compatibility (EMC) Standard for Radio Equipment and Services, Part 17 Specific Conditions for Wideband Data and HIPERLAN Equipment.

EN 55022 Statement (applicable to AP201 Rev 2, AP208 Rev 2 only). This is to certify that the above models are shielded against the generation of radio interference in accordance with the application of Council Directive 2004/108/EC, Annex I, 1a. Conformity is declared by the application of EN 55 022 Class B (CISPR 22). Compliance is dependent upon the use of Cat 5e shielded data cables.

EN 60950-1. Safety of Information Technology Equipment.

EN 50385. Product standard to demonstrate the compliances of radio base stations and fixed terminal stations for wireless telecommunication systems with the basic restrictions or the reference levels related to human exposure to radio frequency electromagnetic fields.



Marking by the alert symbol indicates that usage restrictions apply.

Meru Networks, Inc. declares that their Access Points comply with the essential requirements and other relevant provisions of Directive 1999/5/EC.

Meru Networks, Inc. vakuuttaa täten että Access Points tyyppinen laite on direktiivin 1999/5/EY oleellisten vaatimusten ja sitä koskevien direktiivin muiden ehtojen mukainen.

Hierbij verklaart Meru Networks, Inc. dat het toestel Access Points in overeenstemming is met de essentiële eisen en de andere relevante bepalingen van richtlijn 1999/5/EG.

Bij deze verklaart Meru Networks, Inc. dat deze Access Points voldoet aan de essentiële eisen en aan de overige relevante bepalingen van Richtlijn 1999/5/EC.

Par la présente, Meru Networks, Inc. déclare que l'appareil Access Points est conforme aux exigences essentielles et aux autres dispositions pertinentes de la directive 1999/5/CE.

Par la présente, Meru Networks, Inc. déclare que ce Access Points est conforme aux exigences essentielles et aux autres dispositions de la directive 1999/5/CE qui lui sont applicables.

Härmed intygar Meru Networks, Inc. att denna Access Points står i överensstämmelse med de väsentliga egenskapskrav och övriga relevanta bestämmelser som framgår av direktiv 1999/5/EG.

Undertegnede Meru Networks, Inc. erklærer herved, at følgende udstyr Access Points overholder de væsentlige krav og øvrige relevante krav i direktiv 1999/5/EF.

Hiermit erklärt Meru Networks, Inc. dass sich dieser/diese/dieses Access Points in Übereinstimmung mit den grundlegenden Anforderungen und den anderen relevanten Vorschriften der Richtlinie 1999/5/EG befindet.

Hiermit erklärt Meru Networks, Inc. die Übereinstimmung des Gerätes Access Points mit den grundlegenden Anforderungen und den anderen relevanten Festlegungen der Richtlinie 1999/5/EG.

Con la presente Meru Networks, Inc. dichiara che questo Access Points è conforme ai requisiti essenziali ed alle altre disposizioni pertinenti stabilite dalla direttiva 1999/5/CE.

Por medio de la presente Meru Networks, Inc. declara que el Access Points cumple con los requisitos esenciales y cualesquiera otras disposiciones aplicables o exigibles de la Directiva 1999/5/CE.

Meru Networks, Inc. declara que este Access Points está conforme com os requisitos essenciais e outras disposições da Directiva 1999/5/CE.

Hawnhekk, Meru Networks, Inc. jiddikjara li dan Access Points jikkonforma mal-htigijiet essenzjali u ma provvedimenti oħrajn rilevanti li hemm fid-Dirrettiva 1999/5/EC.

Käesolevaga kinnitab Meru Networks, Inc. seadme Access Points vastavust direktiivi 1999/5/EÜ põhinõuetele ja nimetatud direktiivist tulenevatele teistele asjakohastele sätetele.

Alulírott, Meru Networks, Inc. nyilatkozom, hogy a Access Points megfelel a vonatkozó alapvető követelményeknek és az 1999/5/EC irányelv egyéb előírásainak.

Meru Networks, Inc. týmto vyhlasuje, e Access Points splna základné poiadavky a všetky príslušné ustanovenia Smernice 1999/5/ES.

Meru Networks, Inc. tímto prohlašuje, e tento Access Points je ve shode se základními poadavky a dalšími příslušnými ustanoveními smernice 1999/5/ES.

Šiuo Meru Networks, Inc. deklaruoja, kad šis Access Points atitinka esminius reikalavimus ir kitas 1999/5/EB Direktyvos nuostatas.

Ar šo Meru Networks, Inc. deklare, ka Access Points atbilst Direktivas 1999/5/EK butiskajam prasibam un citiem ar to saistitajiem noteikumiem.

Niniejszym, Meru Networks, Inc., deklaruje, ze Access Points spelnia wymagania zasadnicze oraz stosowne postanowienia zawarte Dyrektywie 1999/5/EC.

These products are intended to be used in all countries of the European Economic Area with the following restrictions:

IEEE 802.11a Restrictions

- These products are for indoor use only (5150–5250 MHz).
- To ensure compliance with local regulations, be sure to set your Access Point to the country in which you are using the Access Point.
- The Meru Access Point products can be used only indoors in the following countries: Austria, Belgium, Bulgaria, Czech Republic, Germany, Cyprus, Denmark, Estonia, Finland, France, Greece, Hungary, Iceland, Ireland, Italy, Latvia, Lithuania, Luxembourg, Malta, The Netherlands, Norway, Portugal, Poland, Romania, Spain, Slovak Republic, Slovenia, Sweden, Switzerland, Turkey, and United Kingdom.

IEEE 802.11b/g Restrictions

France—In all Metropolitan départements, wireless LAN frequencies can be used under the following conditions, either for public or private use:

Indoor use: maximum power (EIRP) of 100 mW for the entire 2400–2483.5 MHz frequency band.

Japan

EN 55022 Statement (applicable to AP201 Rev 2, AP208 Rev 2 only). This is to certify that the above models are shielded against the generation of radio interference in accordance with the application of Council Directive 2004/108/EC, Annex I, 1a. Conformity is declared by the application of EN 55022 Class B (CISPR 22). Compliance is dependent upon the use of shielded data cables.

Singapore

**Complies with
IDA Standards
DB102245**

South Korea

The AP1010e and AP1020e must be connected at the Ethernet port using shielded pair Ethernet (STP) cables only.

Manufacturing Information

The AP1000 is built in Taiwan. Factory information is provided under NDA and upon request.

Distributed Antenna Systems (DAS)

Fortinet does not certify or endorse any specific Distributed Antenna System (DAS) vendors. Fortinet will provide support to Fortinet Wi-Fi customers that use distributed antennas within the terms and conditions of the MeruAssure Terms of Service and in accordance with the customer's support agreement. Fortinet Customer Support will support Fortinet software and hardware, and will work jointly with DAS vendors to identify and troubleshoot issues, but any support related to RF issues, including RF coverage, shall be the responsibility of the DAS vendor.

Fortinet recommends that customers use only a DAS that has been tested to work with Fortinet hardware and software. Fortinet does not provide any site surveys, design or implementation of Wi-Fi over DAS. Fortinet recommends that customers obtain such services from a trained and qualified systems integrator or from their DAS vendor.



Supported PoEs

Supported Power Over Ethernet Devices for Fortinet APs

PoE	Description
ACC-POE-AT-1AC	Mid-Span High Power pre-802.3at PoE injector (1 Port, 110V/220V AC input). Ideal for Fortinet AP300, AP300i, or AP1000; backward compatible with 802.3af, also works with Fortinet AP150.
ACC-POE-AT-12AC	Mid-Span 802.3af+ High Power PoE injector (12 Port, 110V/220V AC input), 19" rack mountable, remote management capable. Ideal for Fortinet AP300, AP300i, or AP1000.
ACC-POE1-24AC	Mid-Span 802.3af PoE injector (24 Port, 110V/220V AC input), ideal for Fortinet AP300, AP300i, or AP1000.
ACC-POE1-24ACDC	Mid-Span 802.3af PoE injector (24 Port, 110V/220V AC or 48V DC input), ideal for Fortinet AP300, AP300i, or AP1000.

